

Hand Pallet Truck AC series

Most Popular! Integrated Hydrocylinder

- ▲ Rubber encapsulated handle comfortable even under extreme temperature conditions.
- ▲ Fully sealed hydraulic unit housing.
- ▲ Single valve cartridge for easy maintenance.
- ▲ Powder coated chassis made of high grade steel.
- ▲ Entry rollers reduce damage to pallets.
- ▲ **Conforms to EN1757-2.**

HOT! SALE

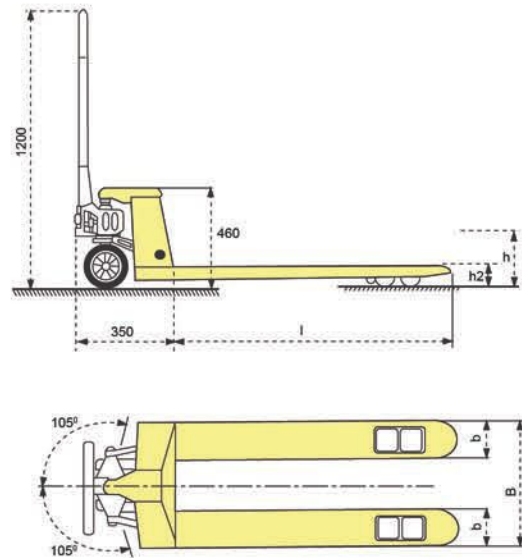

(mm)



Integrated Hydrocylinder

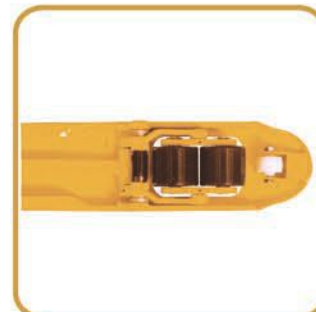

with enter & exit rollers

Model No.	AC20S	AC20L	AC25S	AC25L	AC30S	AC30L
Rated Capacity (kg)	2000		2500		3000	
Lifting Height (mm)	115					
Max. Fork Height h (mm)	200 (or 190)					
Min. Fork Height h2 (mm)	85 (or 75)					
Fork Length l (mm)	1150	1220	1150	1220	1150	1220
Fork Width b (mm)	160	160	160	160	160	160
Width Overall Forks B (mm)	540	685	540	685	540	685
Load Roller (mm)	Tandem $\Phi 80 \times 70$ (or $\Phi 74 \times 70$), Single $\Phi 80 \times 93$ Nylon, Polyurethane					
Steering Wheel (mm)	$\Phi 200 \times 50$ (or $\Phi 180 \times 50$) Nylon, Polyurethane or Rubber					
Net Weight (kg)	75	78	77	80	85	88

* Special fork length like 800mm, 900mm, 950mm, 1000mm, 1500mm, 1800mm, 2000mm are all available.

OPTION

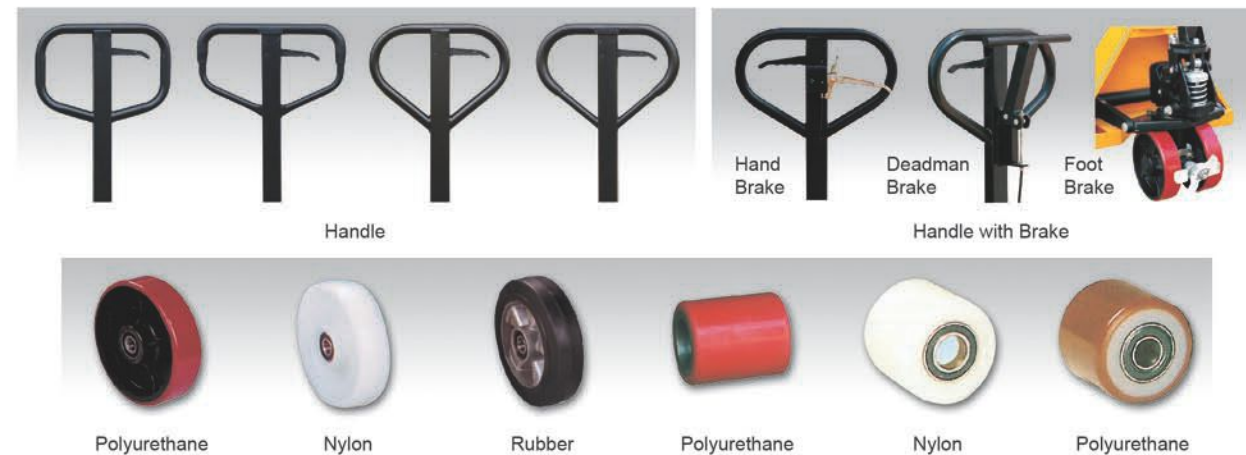

Hand Pallet Truck DF series

High Quality, Welded Hydrocylinder

- ▲ Bushings at key points.
- ▲ Super strong steel structure frame.
- ▲ Tapered fork tips with entry guide roller.
- ▲ Fully adjustable push rods on forks.
- ▲ **Conforms to EN1757-2.**

HOT! SALE



Welded Hydrocylinder



Model No.	DF20S	DF20L	DF25S	DF25L	DF30S	DF30L
Rated Capacity (kg)	2000		2500		3000	
Max. Fork Height (mm)	200 (or 195)					
Min. Fork Height (mm)	85 (or 75)					
Fork Length (mm)	1150	1220	1150	1220	1150	1220
Width Overall Forks (mm)	550	685	550	685	550	685
Individual Fork Width (mm)	160	160	160	160	160	160
Load Roller Dia.xWidth (mm)	Tandem $\Phi 80 \times 70$ (or $\Phi 74 \times 70$), Single $\Phi 80 \times 93$ (or $\Phi 74 \times 93$) Nylon, Polyurethane					
Steering Wheel Dia.xWidth (mm)	$\Phi 200 \times 50$ (or $\Phi 180 \times 50$) Nylon, Polyurethane, Rubber					
Net Weight (kg)	75	78	77	80	85	88

* Special fork length 800mm, 900mm, 950mm, 1000mm, 1500mm, 1800mm, 2000mm are all available.

Hand Pallet Truck BF series

Upgraded integrated Hydrocylinder

- ▲ Bushings at key points.
- ▲ Super strong steel structure frame.
- ▲ Tapered fork tips with entry guide roller.
- ▲ Fully adjustable push rods on forks.
- ▲ **Conforms to EN1757-2.**

HOT! SALE



Integrated Hydrocylinder



Model No.	BF20S	BF20L	BF25S	BF25L	BF30S	BF30L
Rated Capacity (kg)	2000		2500		3000	
Max. Fork Height (mm)	200 (or 195)					
Min. Fork Height (mm)	85 (or 75)					
Fork Length (mm)	1150	1220	1150	1220	1150	1220
Width Overall Forks (mm)	550	685	550	685	550	685
Individual Fork Width (mm)	160	160	160	160	160	160
Load Roller Dia.xWidth (mm)	Tandem $\Phi 80 \times 70$ (or $\Phi 74 \times 70$), Single $\Phi 80 \times 93$ (or $\Phi 70 \times 93$) Nylon, Polyurethane					
Steering Wheel Dia.xWidth (mm)	$\Phi 200 \times 50$ (or $\Phi 180 \times 50$) Nylon, Polyurethane, Rubber					
Net Weight (kg)	75	78	77	80	85	88

* Special fork length 800mm, 900mm, 950mm, 1000mm, 1500mm, 1800mm, 2000mm are all available.

Hand Pallet Truck HP series

- ▲ A built in overload valve and totally sealed hydraulic pump.
- ▲ German seal kit offers long span life of pump.
- ▲ Heavy duty and reinforced forks for greatest strength and durability.
- ▲ Entry rollers prevent physical exertion of the operator and protect load rollers and pallet.
- ▲ Maintenance free oil-less bushings at key points reduce operating force and prolong life span of the pallet truck.
- ▲ **Conforms to EN1757-2.**

**HOT!
SALE**



Casted Hydrocylinder

Model No.	HP20S	HP20L	HP25S	HP25L	HP30S	HP30L
Rated Capacity (kg)	2000		2500		3000	
Max. Fork Height (mm)	205 (or 195)		205 (or 195)		205 (or 195)	
Min. Fork Height (mm)	85 (or 75)		85 (or 75)		85 (or 75)	
Fork Length (mm)	1150	1220	1150	1220	1150	1220
Width Overall Forks (mm)	540	680	540	680	540	680
Individual Fork Width (mm)	160	160	160	160	160	160
Load Roller Dia.xWidth (mm)	Tandem $\Phi 80 \times 70$ (or $\Phi 74 \times 70$), Single $\Phi 80 \times 93$ (or $\Phi 74 \times 93$) Nylon, Polyurethane					
Steering Wheel Dia.xWidth (mm)	$\Phi 200 \times 50$ (or $\Phi 180 \times 50$) Nylon, Polyurethane, Rubber					
Net Weight (kg)	78	82	80	84	85	89

* Special fork length 800mm, 900mm, 950mm, 1000mm, 1500mm, 1800mm, 2000mm are all available.

Hand Pallet Truck BST series

- ▲ German made seal kits afford hydraulic pump.
- ▲ Unique technology on this pump, descending speed is of the load.
- ▲ Longer life span and easily repairable.
- ▲ Fork tip and tapered mounting bracket design for entry roller, provide protection for the roller itself and the load wheel.
- ▲ it is easier for entry and exit from pallet.
- ▲ Heavy-duty design with high quality steel plate and sturdy continuous welds throughout.
- ▲ **Conforms to EN1757-2.**

German Type Cylinder



Model No.	BST2053	BST2068	BST2553	BST2568	BST3054	BST3068
Rated Capacity (kg)	2000		2500		3000	
Max. Fork Height (mm)	205 (or 195)		205 (or 195)		205 (or 195)	
Min. Fork Height (mm)	85 (or 75)		85 (or 75)		85 (or 75)	
Fork Length (mm)	1150	1220	1150	1220	1150	1220
Width Overall Forks (mm)	530	685	530	685	540	680
Individual Fork Width (mm)	150	150	150	150	160	160
Load Roller Dia.xWidth (mm)	Tandem $\Phi 80 \times 70$ (or $\Phi 74 \times 70$), Single $\Phi 80 \times 93$ (or $\Phi 74 \times 93$) Nylon, Polyurethane					
Steering Wheel Dia.xWidth (mm)	$\Phi 200 \times 50$ (or $\Phi 180 \times 50$) Nylon, Polyurethane, Rubber					
Net Weight (kg)	75	78	77	80	85	88

* Special fork length 800mm, 900mm, 950mm, 1000mm, 1500mm, 1800mm, 2000mm are all available.

Low Profile Pallet Truck ACL series

- ▲ Easy access to lowest pallet and containers with min. floor clearance 35mm/51mm.
- ▲ **Conforms to EN1757-2.**

**HOT!
SALE**



Model No.	ACL20S	ACL20L	ACL10S	ACL10L
Type	Low Profile 51mm		Super Low 35mm	
Rated Capacity (kg)	2000	2000	1000	1000
Max. Fork Height (mm)	165	165	90	90
Min. Fork Height (mm)	51	51	35	35
Fork Length (mm)	1150	1220	1150	1220
Fork Overall Width (mm)	540	685	540	685
Net Weight (kg)	74	77	75	78

Rollers: Polyurethane, Steel
Wheels: Nylon, Polyurethane, Rubber

Four-way Pallet Truck HPF series

- ▲ Unique 4-directional movement capacity provides the flexibility to maneuver wide loads through standard aisles.
- ▲ An additional set of wheels allows pallet truck to be moved sideways in addition to conventional forward and backward directions.
- ▲ Move heavy loads, quickly and effortlessly, with convenient hydraulic power and industrial quality features.
- ▲ Include sealed ball bearings on wheels that are permanently lubed and polyurethane coated.
- ▲ Handle has a cushion grip with a 3-position lever.



Capacity: 2000kg at fork height from 85 to 175mm.
1200kg at fork height from 175 to 205mm.

Model No.	HPF20S	HPF20L
Rated Capacity (kg)	2000/1200	2000/1200
Max. Fork Height (mm)	205	205
Min. Fork Height (mm)	85	85
Fork Length (mm)	1150	1220
Width Overall Forks (mm)	540	680
Rear Wheel (mm)	$\Phi 200$	$\Phi 200$
Net Weight (kg)	75	78

5 Ton Pallet Truck HP50 series

- ▲ Heavy duty design for moving heavy load.
- ▲ Unique hydraulic pump with less effort to lift heavy load easily.
- ▲ **Conforms to CE safety standard.**



Load roller: d=Φ80×68mm, tandem steel
Steering wheel: D=Φ200×50mm, steel

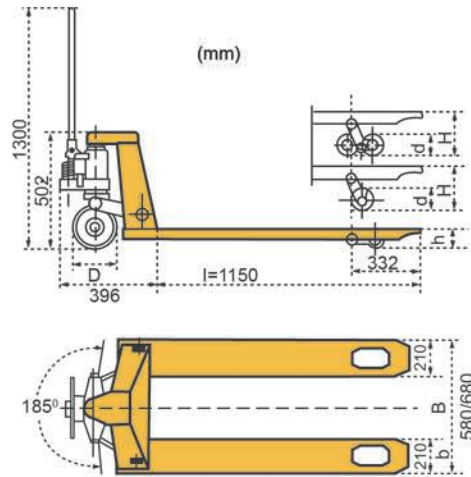

Model No.		HP50S	HP50L
Rated Capacity	(kg)	5000	
Max. Fork Height	H (mm)	200	
Min. Fork Height	h (mm)	90	
Fork Length	l (mm)	1150	
Fork Overall Width	B (mm)	580	680
Single Fork Width	b (mm)	210	
Over Size	L×W×H (mm)	1546×588/688×1300	
Net Weight	(kg)	192	198

Hot Galvanized Pallet Truck ACG series

- ▲ Latest galvanizing technology offers longest span life and prevent corrosion.
- ▲ For use in corrosive environment, cold room or clean room applications.
- ▲ Chrome plated piston and valve.
- ▲ Galvanized structure including fork frame, wheel frame, push rod, handle.
- ▲ Galvanized pump with leak resistant and airless design.
- ▲ 75mm (3") lowered fork height available.
- ▲ **Conforms to EN1757-2.**



Model No.		ACG20S	ACG20L	ACG25S	ACG25L
Rated Capacity	(kg)	2000	2000	2500	2500
Max. Fork Height	(mm)	200(190)	200(190)	200(190)	200(190)
Min. Fork Height	(mm)	85(75)	85(75)	85(75)	85(75)
Fork Length	(mm)	1150	1220	1150	1220
Fork Overall Width	(mm)	540	685	540	685
Fork Width	(mm)	160	160	160	160
Net Weight	(kg)	75	78	77	80

Roll Pallet Truck HR series

- ▲ **Conforms to EN1757-2.**

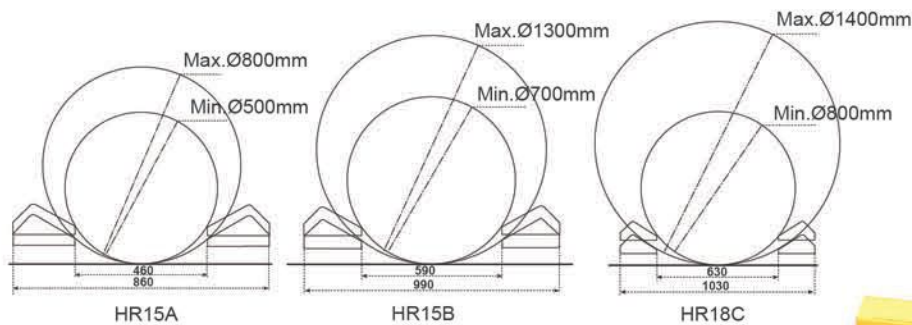

For handling roll of paper, carpet, textile or other cylindrical materials.



Model No.		HR15A	HR15B	HR18C
Rated Capacity	(kg)	1500	1500	1800
Min. Roll Diameter	(mm)	Φ500	Φ700	Φ800
Max. Roll Diameter	(mm)	Φ800	Φ1300	Φ1400
Max. Roll Length	(mm)	1500	1500	1500
Fork Overall Width	(mm)	860	990	1030
Fork Length	(mm)	1350	1350	1350
Rear Wheel	(mm)	Φ200	Φ200	Φ200
Net Weight	(kg)	130	140	155

Stainless Steel Pallet Truck ACS series

- ▲ Material Inox SS304.
- ▲ All parts are made of stainless including hydraulic pump, fork frame, handle, push rod, bearing, pin and bolt, etc.
- ▲ For use in meat and other food industry, dairy canning and all areas where corrosive acids and saline solutions are used.
- ▲ Rollers/Wheels: Nylon.
- ▲ 75mm (3") lowered fork height available.
- ▲ **Conforms to EN1757-2.**

Optional HPS series
INOX316



ACS series
INOX304



Model No.		ACS20S	ACS20L	ACS25S	ACS25L
Rated Capacity	(kg)	2000	2000	2500	2500
Max. Fork Height	(mm)	200	200	200	200
Min. Fork Height	(mm)	85	85	85	85
Fork Length	(mm)	1150	1220	1150	1220
Fork Overall Width	(mm)	540	685	540	685
Fork Width	(mm)	160	160	160	160
Net Weight	(kg)	75	78	77	80

Rough Terrain Truck RP series

- ▲ Great equipment to move heavy loads at any rough terrain area.
- ▲ Ergonomic design of the frame to reduce the operation effort.
- ▲ Meanwhile the truck is robust enough for the purpose to work outside such as builders yard, garden centers where there's only an occasional need for moving pallets by forklifts or where no ordinary forklift or even pallet truck can go.
- ▲ The fork is adjustable for special dimension pallet.
- ▲ **Conforms to EN1757-2.**

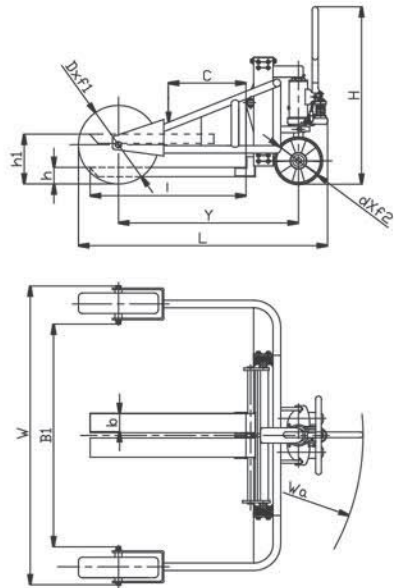

Model No.		RP1000A	RP1250A	RP1500A
Rated Capacity	(kg)	1000	1250/1500	
Max. Fork Height	h1 (mm)	240	240	
Min. Fork Height	h (mm)	70	70	
Fork Length	l (mm)	860	860	
Load Center	C (mm)	430	430	
Adjustable Fork Width	(mm)	216-680	256-680	
Individual Fork Width	b (mm)	100	120	
Distance inside the Front Wheel	B1 (mm)	1230	1230	
Axle Distance between front Wheel and rear steering wheel	Y (mm)	973	973	
front Load Wheel	Dia. x Width (mm)	Φ568X145	Φ568X145	
Rear Steering Wheel	Dia. x Width (mm)	Φ250	Φ250	
Turn Radius	Wa (mm)	1500	1500	
Overall Size	L x W x H (mm)	1406X1670X1280	1406X1670X1280	
Net Weight	(kg)	210	238	258

Electric Rough Terrain Truck ERP series

- ▲ Great equipment to move heavy loads at any rough terrain area.
- ▲ Full Electric Lifting and Driving.
- ▲ Meanwhile the truck is robust enough for the purpose to work outside such as builders yard, garden centers where there's only an occasional need for moving pallets by forklifts or where no ordinary forklift or even pallet truck can go.
- ▲ The fork is adjustable.
- ▲ **Conforms to EN1757-2.**



Model No.		ERP1000	ERP1500
Rated Capacity	(kg)	1000	1500
Min. Fork Height	(mm)	50	50
Max. Fork Height	(mm)	330	330
Fork Length	(mm)	1070	1070
Adjustable Forks Width	(mm)	216-850	256-850
Individual Fork Width	(mm)	100	100
Load Center	(mm)	500	500
Driving wheel	(v/w)	DC24V/1200W	DC24V/1200W
Power Pack	(v/w)	DC24V/800W	DC24V/800W
Front Load Wheel Dia. x Wid.	(mm)	φ406x110	φ406x110
Rear Steering Wheel Dia. x Wid.	(mm)	φ310x100	φ310x100
Distance inside the Front Wheel	(mm)	1270	1270
Overall Size	(mm)	1750x1580x1240	1750x1580x1240
Net Weight	(kg)	210	238

Weighing Pallet Truck ZF / ZFP series

- ▲ High accuracy with fixed load cell mounting.
- ▲ High level of water and humidity resistance.
- ▲ Long term reliability from a single circuit board with any extra connectors.
- ▲ Lower power consumption, auto shut off: 4 AA new batteries can last up to one year.
- ▲ Summation of weights with sequence number. Auto tare.
- ▲ Accuracy 0.1% of the weight applied to the scale. 1kg graduation.
- ▲ Plus model for 0.5kg graduation is available for special order.
- ▲ Optional thermal printer integrated with the housing.



indicator without printer



indicator with printer



Model No.		ZF20S	ZF20L	ZFP20S	ZFP20L	ZFC20S	ZFC20L
Capacity	lbs (kg)	5000 (2300)					
Printer		RAVAS/without printer		RAVAS/with printer		Chinese Indicator/without printer	
Max. Fork Height	inch (mm)	8.1 (205)					
Min. Fork Height	inch (mm)	3.35 (85)					
Fork Length	inch (mm)	45 (1150)					
Fork Width	inch (mm)	7 (180)					
Width Overall Forks	inch (mm)	22 (555)	27 (690)	22 (555)	27 (690)	22 (555)	27 (690)
Net Weight	lbs (kg)	257 (117)	264 (120)	260 (118)	266 (121)	275 (125)	277 (126)

Weighing Pallet Truck ACW / ACWP series

- ▲ High accuracy with fixed load cell mounting.
- ▲ High level of water and humidity resistance.
- ▲ Long term reliability from a single circuit board with any extra connectors.
- ▲ Summation of weights with sequence number. Auto tare.
- ▲ Accuracy 0.05% of the weight applied to the scale. 1kg graduation.
- ▲ Plus model for 0.5kg graduation is available for special order.
- ▲ Optional thermal printer integrated with the housing.
- ▲ Steel display protection for shipping and operations.
- ▲ Optional stainless steel SS304, high grade IP48 water-proof.



Model No. (without printer)		ACW20S	ACW20L	ACW25S	ACW25L
Model No. (with printer)		ACWP20S	ACWP20L	ACWP25S	ACWP25L
Weighing Capacity	(kg)	2000	2000	2500	2500
Min. Fork Height	(mm)	78	78	78	78
Max. Fork Height	(mm)	195	195	195	195
Fork Length	(mm)	1150	1220	1150	1220
Overall Forks Width	(mm)	540	680	540	680
Individual Fork Width	(mm)	160	160	160	160
Graduation	(kg)	0.5	0.5	0.5	0.5
Weighing accuracy	(%)	0.05	0.05	0.05	0.05
Net Weight	(kg)	125	130	125	130

Weighing Pallet Truck RHM / RHMP series

- ▲ This system is built and approved according to legal for trade norms, which allows use of the pallet truck scale for commercial transactions to invoice clients based on weight.
- ▲ To protect the clients interests, these legal for trade systems are verified to be accurate independent of temperature and humidity changes, position of weight or floor conditions, distortion from signals coming from mobile telephones or other radio frequency signals.
- ▲ NTEP Approved Legal for Trade Class III truck.



NTEP Certified.

Legal for trade!

RHM20S

Specification

- ▲ Capacity 2000 kg
- ▲ Graduation 1 kg up to 2000 kg
- ▲ Exchangeable battery module with 80 operation hours between charging.
- ▲ Supplied with battery charger adaptor.
- ▲ IP65 enclosure.
- ▲ A level control device will give a message on the display when the system is more than 2 degrees out of level.
- ▲ According to ROSH directive and conforms to EN1752-2.

Options :

- Printer:
Thermal printer head (needs no ink)
Paper width 53mm.
Graduation 0.5 kg up to 1500 kg.

Model No.	RHM20S	RHM20L	RHMP20S	RHMP20L
Weighing Capacity (kg)		2000		
Printer	without printer		with printer	
Max. Fork Height (mm)		205		
Min. Fork Height (mm)		85		
Fork Length (mm)		1150		
Fork Width (mm)		180		
Width Overall Forks (mm)	555	690	555	690
Net Weight (kg)	122	127	122	127

*** 3" (75mm) lowered fork height available as standard.
*** Special purpose weighing trucks are available.

Weighing Pallet Truck HPW series

- ▲ Type A Equipped with a top quality sensor and scale meter from Mettler-Toledo, USA. Features weighing accuracy ± 1 kg in 2000kg.
- ▲ Type B Equipped with a high quality Japanese sensor and Mettler-Toledo, USA. Features weighing accuracy ± 2 kg in 2000kg.
- ▲ Rollers/Wheels: Nylon, Polyurethane, Rubber. Materials and specification are subject to change without notice.
- ▲ Load capacity upto 2500kg and 3000kg



Model No.	HPW20S-A	HPW20L-A	HPW20S-B	HPW20L-B
Type	A		B	
Capacity (kg)		2000		
Max. Fork Height (mm)		205		
Min. Fork Height (mm)		85		
Fork Length (mm)		1150		
Fork Width (mm)		168		
Width Overall Forks (mm)	555	690	555	690
Net Weight (kg)	85	88	85	88

Stainless Weighing Truck ZFG / ZFS series

- ▲ Galvanized or stainless(#316) model offers longest span life and prevent corrosion.
- ▲ The same specification as model ZF/ZFP.



ZFG20S



ZFS20S

Model No.	ZFG20S	ZFG20L	ZFS20S	ZFS20L
Capacity (kg)			2000	
Max. Fork Height (mm)			205	
Min. Fork Height (mm)			85	
Fork Length (mm)			1150	
Fork Width (mm)			180	
Width Overall Forks (mm)	555	690	555	690
Net Weight (kg)	117	120	129	132

Stainless Weighing Truck ACWS / ACWSP series

- ▲ High accuracy with fixed load cell mounting.
- ▲ High level of water and humidity resistance.
- ▲ Long term reliability from a single circuit board with any extra connectors.
- ▲ Summation of weights with sequence number.Auto tare.
- ▲ Accuracy 0.1% of the weight applied to the scale. 1kg graduation.
- ▲ Stainless steel SS304, high grade IP48 water-proof.



Optional Explosion-proof indicator



Model No.(without printer)		ACWS20S	ACWS20L	ACWS25S	ACWS25L
Model No.(with printer)		ACWSP20S	ACWSP20L	ACWSP25S	ACWSP25L
Weighing Capacity (kg)		2000	2000	2500	2500
Min. Fork Height (mm)		78	78	78	78
Max. Fork Height (mm)		195	195	195	195
Fork Length (mm)		1150	1220	1150	1220
Overall Forks Width (mm)		540	680	540	680
Individual Fork Width (mm)		160	160	160	160
Graduation (kg)		0.5	0.5	0.5	0.5
Weighing accuracy (%)		0.05	0.05	0.05	0.05
Net Weight (kg)		125	130	125	130

High Lift Scissor Truck HB series

- ▲ **World class quality and performance.**
- ▲ **Single stage cylinder.**
No decrease of capacity.
No risk of leakage.
No dangerous dropping of second stage cylinder.
- ▲ **Ergonomic design handle.**
Simple and comfortable operation.
- ▲ **Improved safety.**
Automatic activation of self-adjusting stabilizers when lifting loads higher than 400mm for maximum stability and optimal braking.
- ▲ **1801213-1801216 Manual.**
Quick-lift function doubles the lifting speed when lifting loads less than 250kg.
- ▲ **1801217-1801220 Battery Operated.**
- ▲ **Easy handling**
The compact structure with the battery and power unit positioned between body and lifting cylinder resulting in a low centre of gravity and excellent maneuverability.
- ▲ **Flexibility**
Can work manually when the battery electric unit works manually as well when battery is being charged.
- ▲ **Charger**
6A/12V Built-in.
- ▲ **Reliable**
HPI power unit made in France.
- ▲ **Conforms to EN1757-4 and EN1175.**

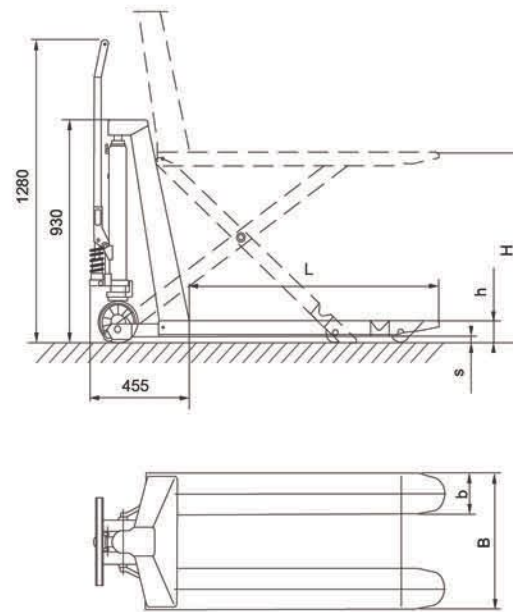
Manual Type

HOT! SALE

Battery operated

Ergonomic Handle

Built-in Charger

Model No.	HB1056M	HB1068M	HB1556M	HB1568M	HB1056EN	HB1068EN	HB1556EN	HB1568EN
Type	Manual				Electric (built in charger)			
Capacity (kg)	1000				1500			
Max. Fork Height H (mm)	800				800			
Min. Fork Height h (mm)	85 ± 2				85 ± 2			
Fork Width B (mm)	560	680	560	680	560	680	560	680
Fork Length L (mm)	1190	1190	1150	1150	1190	1190	1150	1150
Ground Clearance s (mm)	20							
Front Load Roller (mm)	Ø75x75							
Steering Wheel (mm)	Ø180x50							
Pump Strokes to Max. Height without / with Rated Load	28/62	28/62	28/62	28/62	—	—	—	—
Lifting Time, without / with Rated Load (sec)	—	—	—	—	11/19	11/19	11/25	11/25
Battery (Ah/V)	—	—	—	—	70/12	70/12	70/12	70/12
Battery Charger (A/V)	—	—	—	—	6/12	6/12	6/12	6/12
Net Weight (without Battery) (kg)	128	133	143	148	159	164	171	176

High Lift Scissor Truck NH series Single-stage piston

- ▲ **Economic version but reliable.**
- ▲ **Single stage cylinder.**
No decrease of capacity.
No risk of leakage.
No dangerous dropping of second stage cylinder.
- ▲ **High quality power unit.**
- ▲ **Safety:** Patented safety system on handle to prevent accidental touch of the release handle thus causing sudden sliding down of the fork, you can screw the release handle tight in slow or quick lifting position.
Quick lift as standard.
- ▲ **Conforms to EN1757-4.**

Model No.	NH10S	NH10L
Rated Capacity (kg)		1000
Max. Fork Height H (mm)		800
Min. Fork Height h (mm)		85 ± 2
Fork Overall Width B (mm)	540	680
Fork Length L (mm)		1150
Front Load Roller (mm)		Ø75x75
Steering Wheel (mm)		Ø180x50
Pump Strokes to Max. Height without load /with rated load	11/19	11/19
Net Weight (without battery) (kg)	110	115



High Lift Scissor Truck JL series Double-stage piston

- ▲ **Character:** Extremely easy to pump and light make this unit very suitable as combined hand pallet truck and lift table.
- ▲ Quick-lift as standard with automatic transfer to normal lifting with loads over 150kg.
- ▲ Automatic descending speed control by a uniquely hydraulic valve, the descending speed always keeps same regardless the truck with or without load. It will prevent cargo damage from fast descending.
- ▲ Front support legs and adjustable stabilizers extended to the floor automatically when the forks reach a height of 420mm, to ensure maximum stability and optimum braking.
- ▲ Ergonomic warm handle offers you simple and comfortable operation.
- ▲ Heavy duty design: 4mm steel plate fork frame and larger lift piston ensure the truck to reach rated capacity.
- ▲ **Conforms to EN1757-4.**

JL model

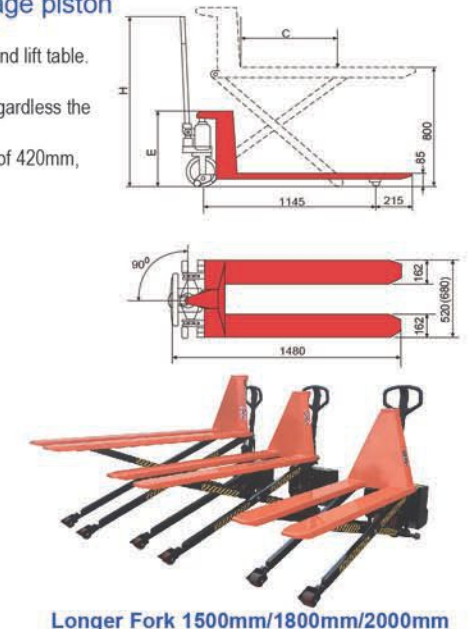
JE model

Model No.	JL5210	JE5210	JL6810	JE6810	JL5215	JE5215	JL6815	JE6815
Rated Capacity (kg)	1000				1500			
Max. Fork Height (mm)	800				85			
Min. Fork Height (mm)	85				85			
Fork Overall Width (mm)	520		680		520		680	
Fork Length (mm)	1140				1100			
Dimension	C (mm)	600			560	600	560	600
	E (mm)	530						
	H (mm)	1250						
Battery (Ah/V)	--	70/12	--	70/12	--	70/12	--	70/12
Battery Charger (A/V)	--	8/12	--	8/12	--	8/12	--	8/12
Net Weight (kg)	105	140	112	147	118	149	125	157

High Lift Scissor Truck HL series

HOT! SALE

▲ **Manual**

Capacity 1000kg (2200lbs).
Larger piston offer real 1000kg full capacity.

▲ **Conforms to EN 1757-4.**



HL-540M



HL-540E

▲ **Electric**

Capacity 1000kg (2200lbs).
High quality hydraulic motor made in Italy.

▲ **Conforms to EN 1757-4 and EN 1175.**

Model No.	HL-540M	HL-680M	HL-540E	HL-680E
Type	Manual		Electric	
Capacity (kg)	1000 (2200lbs)		1000 (2200lbs)	
Max. Fork Height (mm)	800 (31.5 inch)		800 (31.5 inch)	
Min. Fork Height (mm)	90 (3.5 inch)		90 (3.5 inch)	
Fork Overall Width (mm)	540 (21.3 inch)	680 (26.8 inch)	540 (21.3 inch)	680 (26.8 inch)
Fork Length (mm)	1165 (45.3 inch)		1165 (45.3 inch)	
Battery (Ah/V)	—		54/12	
Battery Charger (A/V)	—		8/12	
Net Weight (without battery) (kg)	110 (242lbs)	125 (275lbs)	150 (330lbs)	165 (363lbs)

Rollers: Nylon, Polyurethane. Wheels: Nylon, Polyurethane, Rubber.
Materials and specification are subject to change without notice.

Stainless High Lift Scissor Truck HS series

HOT! SALE

▲ All parts are made of stainless steel hydraulic pump, fork frame, handle, push rod, bearing, pin and bolt, etc.

▲ For use in meat and other food industry, dairy canning and all areas where corrosive acids and saline solutions are used.



HS540E



HS540M

Model No.	HS540M	HS680M	HS540E	HS680E
Type	Manual		Electric	
Capacity (kg)	1000	1000	1000	1000
Max. Fork Height (mm)	800	800	800	800
Min. Fork Height (mm)	85	85	85	85
Fork Width (mm)	540	680	540	680
Fork Length (mm)	1165	1165	1165	1165
Battery (Ah/V)	—		54/12	54/12
Net Weight (kg)	116	126	144	149

Skid Lifter SL/PL / PE/PEL series

Easier handling to minimize back strain.
Better feature - it can move when raised.

- ▲ Combination of pallet truck and lift table.
- ▲ Ideal for your loading and unloading operations.
- ▲ Continuous-welded heavy steel frame and forks handle weighty loads with ease.
- ▲ Easy-to-use control lever plus two parking brakes on steering wheels increase safety.
- ▲ Reliable power unit for easier and faster lifting.
- ▲ Additional steering handle on 1000kg models for easier and comfortable turning.
- ▲ **Conforms to EN1757-4 and EN1175(For Electric).**

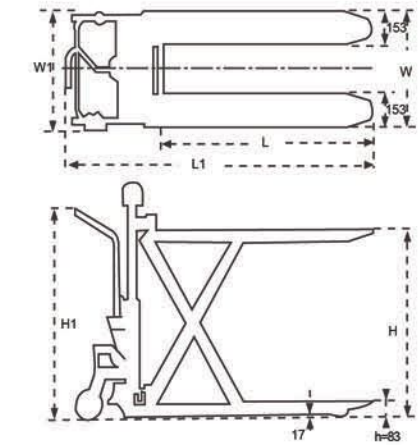

SL50S



PL50S



PE50S



PEL50S

Model No.	SL50S	SL50L	SL100S	SL100L	PL50S	PL50L	PL100S	PL100L	PE50S	PE50L	PE100S	PE100L	PEL50S	PEL50L	PEL100S	PEL100L
Type	Manual				with platform				Electric				with platform			
Platform	—				with platform				—				with platform			
Capacity (kg)	500	—	1000	—	500	1000	—	—	500	—	1000	—	500	1000	—	—
Load Center (mm)	—				560				—				—			
Max. Fork Height H (mm)	830				833				830				833			
Min. Fork Height h (mm)	85				88				85				88			
Fork/Platform Length L (mm)	1115															
Fork/Platform Width W (mm)	526	690	526	690	538	703	538	703	526	690	526	690	538	703	538	703
Overall Width W1 (mm)	526	691	687	852	538	703	693	858	580	740	550	720	586	752	556	726
Overall Length L1 (mm)	1550	—	1640	—	1550	—	1640	—	1620	—	1740	—	1620	—	1740	—
Overall Height H1 (mm)	1012	—	1307	—	1012	—	1307	—	1050	—	1307	—	1050	—	1307	—
Front Roller (mm)	Ø70x68 polyurethane															
Steering Wheel (mm)	Ø150x40 polyurethane															
Pump Strokes to Max. Lift	45	45	75	75	45	45	75	75	—							
Power Unit (KW)	—								1.6							
Battery (V)	—								12							
Working Cycles (s)	—								100	80	100	80	100	80	100	80
Net Weight (kg)	107	116	135	138	122	136	150	158	172	176	174	180	180	184	182	188

Pallet Tilter LT / LTS series

- ▲ Designed to allow the user to ergonomically reach loads easily without having to bend down or over-stretch.
- ▲ Handle can be turned and locked in position away from the work area.
- ▲ Applies to both sitting and standing positions.
- ▲ Forks can be tilted up to 90°.
- ▲ Both are supplied as standard with parking brake and foot protectors.
- ▲ **Conforms to EN1757-1 and EN 1175.**

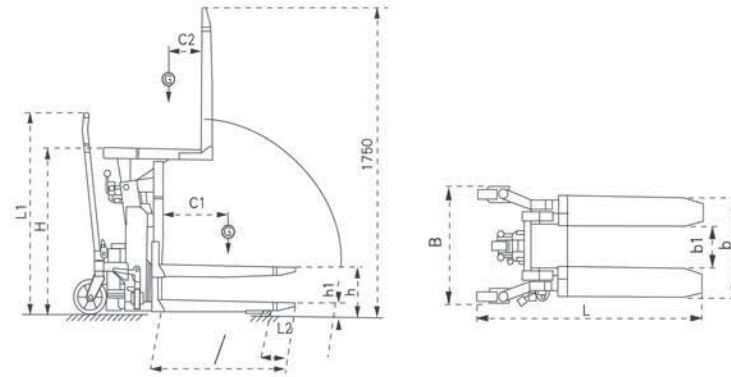
LT10M

LT10E

LTS10M

All Stainless Steel
LTS10E

Model No.	LT10M	LT10E	LTS10M	LTS10E
Operation Type	Manual	Electric	Manual	Electric
Capacity (kg)	1000		1000	
Lifting Height, Vertical h (mm)	285		285	
Min. Fork Height h1 (mm)	85		85	
Fork Length l (mm)	800		800	
Handle Height L1 (mm)	1138		1138	
Overall Fork Width b (mm)	560		560	
Width Between Forks b1 (mm)	234		234	
Fork Tip Length from Roller L2 (mm)	135		135	
Overall Width B (mm)	638		638	
Overall Length L (mm)	1325	1410	1325	1410
Overall Height, Raised H (mm)	950		950	
Overall Height, Lowered H (mm)	750		750	
Load Centre Min. /Max. C1 (mm)	200/400		200/400	
Load Centre Min. /Max. C2 (mm)	200/420		200/420	
Power Unit (KW/V)	—	0.8/12	—	0.8/12
Net Weight (kg)	178	185	178	185

Electric Pallet Truck MHP series

- ▲ Both Lifting & Moving by battery; Lowering by hand.
- ▲ Compact design, cost-effective.
- ▲ Continuous working time 3-4 hours.
- ▲ High quality quick charge ternary soft pack lithium battery.
- ▲ Brake system: Integral electromagnetic disk brake mounted on motor shaft.
- ▲ Drive wheel: Complete gear train mounted on ball and roller bearing in grease bath housing.
- ▲ Warranty is 3 years.
- ▲ **Conforms to EN1757-2.**



Optional: Weighing

 Galvanized
Stainless steel
available

 Brake with power release function
can move when power limited

Model No.	MHP15	MHP20	MHP15E	MHP20E
Operation Type	Semi-Electric/Walkie		Electric/Walkie	
Load Capacity (kg)	1500	2000	1500	2000
Load Center (mm)	600	600	600	600
Wheel Base (mm)	1170/1240		1202/1272	
Fork Width (mm)	540/680		540/680	
Fork Length (mm)	1150/1220		1150/1220	
Min. Fork Height (mm)	85		85	
Max. Fork Height (mm)	200		200	
Overall Length (mm)	1540/1610		1540/1610	
Overall Width (mm)	540/680		540/680	
Operation Handle Height (mm)	1250		1250	
Min. Turning Radius (mm)	1320/1390		1340/1410	
Driving Speed (laden/unladen) (km/h)	4/4.5		4/4.5	
Gradeability (laden/unladen) (%)	2/20		2/20	
Driving Motor (kw)	DC 0.45		DC 0.45	
Lifting Motor (kw)	/		DC 0.45	
Battery (v/Ah)	Lithium 24/20		Lithium 24/20	
Controller	UK PG (water-proof)		UK PG (water-proof)	
Service weight (kg)	125		135	

Electric Pallet Truck MPP series

- ▲ Both Lifting & Moving by electric.
- ▲ Compact design with similar size of common pallet truck, cost-effective.
- ▲ Continuous working time 3-4 hours.
- ▲ Controller: Curtis; Power Pack: Italy Bucher.
- ▲ 24V/25Ah Lithium Battery;
- ▲ Brake system: Integral electromagnetic disk brake mounted on motor shaft.
- ▲ Drive wheel: Complete gear train mounted on ball and roller bearing in grease bath housing.
- ▲ Warranty is 3 years.

**HOT!
SALE**



Model No.	MPP15A	MPP15B	MPP20B
Operator Type	Electric/Walkie	Electric/Walkie	Electric/Walkie
Load Capacity (kg)	1500	1500	2000
Load Center (mm)	600	600	600
Wheelbase (mm)	1202	1220	1220
Overall Height (mm)	1250	1250	1250
Lift Height (mm)	200	190	190
Fork Height(Lowered) (mm)	85	85	85
Overall Length (mm)	1540	1540	1540
Overall Width (mm)	560/680	560/680	560/680
Fork Size (mm)	560/680x1150	560/680x1150	560/680x1150
Lift Motor (KW)	0.50	0.50	0.75
Travel Motor (KW)	0.50	0.50	0.50
Travel Speed(laden/unladen) (Km/h)	4/4.5	4/4.5	4/4.5
Max Gradeability(laden/unladen) (%)	3/5	3/5	3/5
Battery (V/Ah)	24/25	24/25	24/25
Turning Radius (mm)	1350/1420	1350/1420	1350/1420
Service Weight (kg)	125/130	125/130	130/135

Electric Pallet Truck EPC series

- ▲ Maneuver loads up ramps and dockboards effortlessly.
- ▲ Compact design combines with new technology, making this pallet truck ideal for narrow, cramped aisles. shortest head length in the market permits the best possible maneuverability.
- ▲ Smooth stepless speed control with European technology.
- ▲ Power unit with European technology.
- ▲ Powerful traction battery.
- ▲ Powerful maintenance free AC drive motor.
- ▲ Drive unit with electromagnetic brake.
- ▲ **Conforms to EN1726 and EN1175-1.**

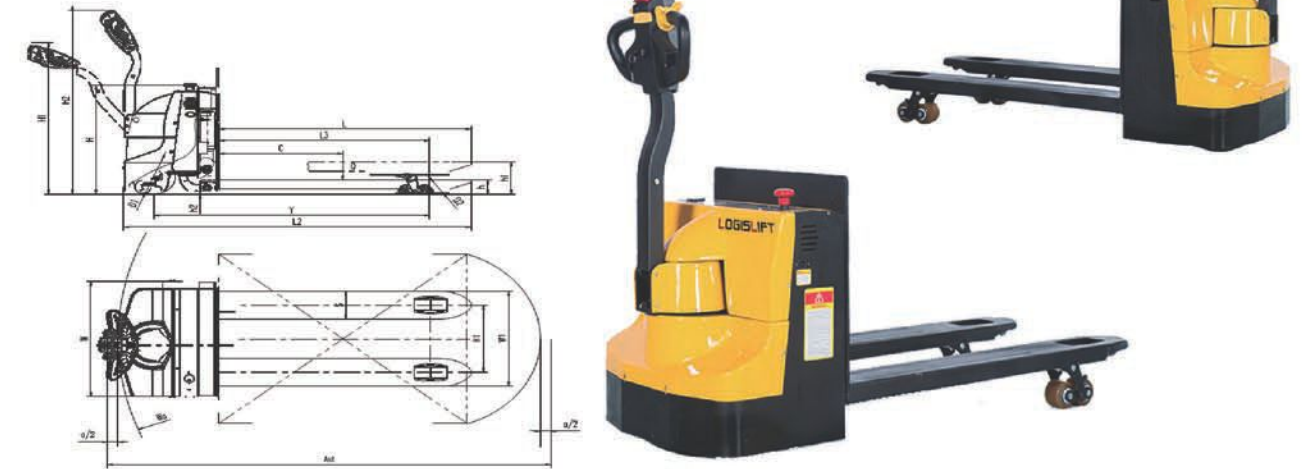

Item	Model No.	EPC1500		EPC2000	
		Full Electric			
Q	Load Capacity (kg)	1500		2000	
C	Load Center (mm)		600		
Y	Wheelbase (mm)		1255		
h13	Min. Fork Height (mm)		85		
h3	Max. Fork Height (mm)		200		
L	Fork Dimensions (mm)		1150x162x54		
b5	Fork spread (mm)		680		
L1	Overall length (mm)		1610		
L2	Length to face of forks (mm)		460		
b1	Overall width (mm)		680		
h14	Height of tiller arm in operating position (min./max.) (mm)		720/1175		
Ast	Aisle width(800x1200mm pallet) (mm)		2400		
Ast	Aisle width(1000x1200mm pallet) (mm)		2300		
X	Load distance (mm)		1018		
b11	Tread (load side) (mm)		378 (398)		
m2	Ground clearance (mm)		20		
Wa	Outer turning radius (mm)		1430		
	Travel speed (laden/unladen) (km/h)		2.5/3		
	Lifting speed (laden/unladen) (mm/s)		35/45		
	Lowering speed (laden/unladen) (mm/s)		50/40		
	Maximum gradeability, S2.5 min.(laden/unladen) (%)		5/7		
	Service brake		Electromagnetic		
	Service weight (Incl. battery) (kg)		260		
	Driving Motor (Kw)		0.75		
	Lifting Motor (Kw)		0.8		
	Tyre type, operator/load side		PU/ PU		
	Tyre size, operator side		Φ220		
	Tyre size, load side		2-Φ78×60		
	Battery (V/Ah)		2×12/65(Maintenance free)		
	Battery Weight (kg)		15×2		
	Controller		Curtis		

Electric Pallet Truck TE / TK series

DC/AC Technology

- ▲ Maneuver loads up ramps and dockboards effortlessly.
- ▲ Compact design combines with new technology, making this pallet truck ideal for narrow, cramped aisles. shortest head length in the market permits the best possible maneuverability.
- ▲ Smooth stepless speed control with European technology.
- ▲ Power unit with European technology.
- ▲ Powerful traction battery.
- ▲ Powerful maintenance free AC drive motor.
- ▲ Drive unit with electromagnetic brake.
- ▲ **Conforms to EN1726 and EN1175-1.**

**HOT!
SALE**



TE Model



TK Model with Platform & Armrest

Option



Ergonomic Tiller
Made in Germany

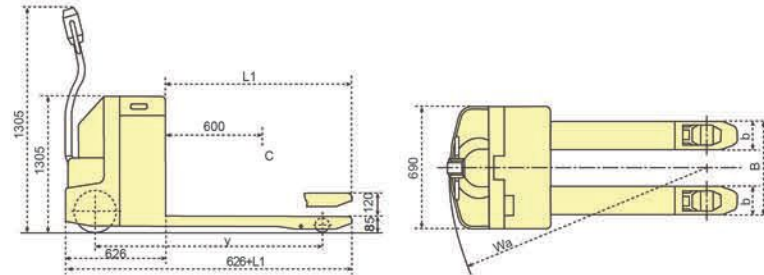

Model No.	TE20S-DC/TE20L-DC	TK20S-DC/TK20L-DC
Model No.	TE20S-AC/TE20L-AC	TK20S-AC/TK20L-AC
Type	without platform	with platform
Capacity (kg)	2000	2000
Load Center C (mm)	600	600
Max. Fork Height H (mm)	205	205
Min. Fork Height h (mm)	85	85
Fork Length L1 (mm)	1150	1150
Individual Fork Width b (mm)	160	160
Wheel Base y (mm)	1406	1406
Turning Radius Wa (mm)	1608	1946
Traveling Speed With/Without Load (Km/h)	3.6/5.4	3.6/5.4
Lifting Speed With/Without Load (mm/s)	22/32	22/32
Lowering Speed With/Without Load (mm/s)	50/55	50/55
Drive Wheel	1200W, Φ250mm (DC)	1200W, Φ250mm (DC)
Power Unit (lifting motor) (W/V)	800/24	800/24
Traction Battery	24V/210Ah, 185kg	24V/210Ah, 185kg
Battery Charger	25A/24V	25A/24V
Overall Dimension L×W×H (mm)	1781×690×1305	2125×690×1305
Fork Overall Width B (mm)	530	680
Net Weight (kg)	324	338
Tiller	○	○

○ = Option

* Load capacity 2.5Ton / 3Ton Available

Electric Pallet Truck EPT series

AC/EPS Technology

- ▲ Heavy duty design, both Lifting & moving by battery..
- ▲ Electronic power steering system, light and low noise.
- ▲ AC driving system, brushless, maintenance free.
- ▲ US Curtis driving control system.
- ▲ Emergency reserving device and emergency brake switch.
- ▲ Electromagnetic, regenerative braking system.
- ▲ Curve automatic deceleration devices, more safer.
- ▲ Stepless speed control system.
- ▲ Automatic speed reduction when steering.
- ▲ Min. height of fork 75mm

**HOT!
SALE**

**AC
EPS**



Model No.	EPT20	EPT25	EPT30
Load Capacity (kg)	2000	2500	3000
Load Center (mm)		600	
Operator type	Walkie/Stand on		
Electric Power-assisted Steering (EPS)	optional		
Min. Fork Height (mm)		85	
Max. Fork Height (mm)		200	
Height of tiller arm min./max. (mm)		1030/1200	
Rear body height (mm)		830	
Rear body length (mm)		688	
Standard fork width (mm)		580	
Fork length (mm)		1150	
Single fork width (mm)		185	
Overall Length (mm)		1838/2378(with platform)	
Overall width (mm)		800	
Min. turning radius (mm)		1700	
Clearance (mm)		40	
Aisle width(800x1200mm pallet) (mm)		2368/2858(with platform)	
Aisle width(1000x1200mm pallet) (mm)		2456/2946(with platform)	
Max.traveling speed (laden/unladen) (km/h)		5/5.3	
Max.lifting speed(laden/unladen) (mm/s)		35/45	
Max.lowering speed(laden/unladen) (mm/s)		50/40	
Gradeability(laden/unladen) (%)		2/5~6/9	
Service weight without battery (kg)		490	
Service weight with battery (kg)		700	
Front load roller size (mm)		FU, 78	
Rear steering wheel size (mm)		FU, 230	
Balance wheel size (mm)		FU, 124	
Wheel base (mm)		1435	
Traveling motor (kw)		1.5(vertical)	2.2(vertical)
Lifting motor (kw)		3	
Voltage (v)		24	
Battery type (Ah)		210/280/340	
Max. battery box size (mm)		790x210x576	
Brake type		Electromagnetic	
Controller type		Curtis	

Electric Pallet Truck CBL series

- ▲ Both Lifting & moving by battery.
- ▲ Mechanical Steering or Electronic power steering system for options.
- ▲ AC driving system, brushless, maintenance free.
- ▲ US Curtis AC driving control system.
- ▲ Short wheelbase with small turning radius, suitable for narrow space.
- ▲ Electromagnetic, regenerative braking system.
- ▲ Curve automatic deceleration devices, more safer.
- ▲ Stepless speed control system.



Model No.	CBL15-DC	CBL20-AC	CBL20EPS
Type	Full Electric	Full Electric	Full Electric/ ESP
Operation type	Walkie	Walkie	Walkie
Load capacity (kg)	1500	2000	2000
Load center (mm)	600	600	600
Fork width (mm)	550/600/650/685		540/600/650/685
Fork length (mm)	1150/1200		
Wheel base (mm)	1300		1390
Driving wheel size (mm)	Φ228*75	Φ228*75	Φ248*75
Balance wheel size (mm)	Φ115*55	Φ115*55	Φ115*55
Front wheel size (mm)	Φ84*80	Φ84*80	Φ84*80
Min. Fork height (mm)	85	85	85
Max. Fork height (mm)	195	195	195
Overall length (mm)	1650		1750
Overall width (mm)	725		720
Operate handle height (mm)	1380		1385
Min. turning radius (mm)	1450		1570
Min. aisle pallet 800*1200 (mm)	1866		1900
Min. aisle pallet 1000*1200 (mm)	1921		1940
Driving speed, laden/unladen (km/h)	3.5/4.0		
Lifting speed, laden/unladen (mm/s)	30/35		
Lowering speed, laden/unladen (mm/s)	40.35		
Gradeability, laden/unladen (%)	5/7		
Driving Motor/Lifting Motor/Steering Motor (kw)	AC 0.95/ DC 1.2		AC 1.5/ DC 1.2/ DC 0.15
Battery (v/Ah)	24/210		
Controller	Curtis		
Battery Weight (kg)	202		
Service weight with battery (kg)	552	562	620

Electric Pallet Truck CBR series

- ▲ High driving speed 11km/h.
- ▲ ESP system, mute, energy saving, light.
- ▲ AC driving system, brushless, maintenance free.
- ▲ US Curtis AC driving control system.
- ▲ Emergency reserving device and emergency brake switch.
- ▲ Electromagnetic, regenerative braking system.
- ▲ Excellent design, easily in and out of the double tray pallet.
- ▲ Half a cockpit design, care for safety.
- ▲ Options: side-way battery 280Ah

EPS AC



Model No.	CBR20
Type	Full Electric
Operation type	Stand-on
Load capacity (kg)	2000
Load center (mm)	600
Fork width (mm)	550/600/650/685
Fork length (mm)	1150/1200
Driving wheel size (mm)	Φ248*75
Balance wheel size (mm)	Φ115*55
Front wheel size (mm)	Φ84*80
Min. Fork height (mm)	85
Max. Fork height (mm)	205
Overall length (mm)	1826
Overall width (mm)	790
Operate handle height (mm)	1170
Min. turning radius (mm)	2278
Min. aisle pallet 800*1200 (mm)	2568
Min. aisle pallet 1000*1200 (mm)	2589
Driving speed, laden/unladen (km/h)	10/11
Lifting speed, laden/unladen (mm/s)	30/35
Lowering speed, laden/unladen (mm/s)	40/35
Gradeability, laden/unladen (%)	15/10
Driving Motor/Lifting Motor/Steering Motor (kw)	AC 3.0/ DC 1.2/ DC 0.15
Battery (v/Ah)	24/280
Controller	Curtis
Battery Weight (kg)	250
Service weight with battery (kg)	860

Electric Pallet Truck CBF series

- ▲ Electronic power steering system, light and low noisy.
- ▲ Driving unit floating bodies with patent design.
- ▲ AC driving system, brushless, maintenance free.
- ▲ US Curtis driving control system.
- ▲ Emergency reserving device and emergency brake switch.
- ▲ Electromagnetic, regenerative braking system.
- ▲ Load backrest, side-way battery.
- ▲ Stepless speed control system.
- ▲ Curve automatic deceleration devices, more safer.

EPS **AC**



Model No.	CBF35A	CBF35B	CBF35C
Type	Full Electric/ Double pallet	Full Electric/ Single pallet	Full Electric/ Single pallet
Operation type	Rider	Rider	Walkie
Load capacity (kg)	3500	3500	3500
Fork width (mm)	680	680	680
Fork length (mm)	2432	1212/1365/1517	1212/1365/1517
Wheel base (mm)	2084	1602	1602
Driving wheel size (mm)	Φ300*120	Φ300*120	Φ300*120
Balance wheel size (mm)	Φ115*55	Φ115*55	Φ115*55
Front wheel size (mm)	Φ84*152	Φ84*152	Φ84*152
Min. Fork height (mm)	85	85	85
Max. Fork height (mm)	230	230	230
Overall length (mm)	3605	2374	2222
Overall width (mm)	930	930	930
Operate handle height (mm)	1536	1536	1536
Min. turning radius (mm)	2708	2190	2051
Min. aisle pallet 1200*1200 (mm)	3650	2536	2356
Driving speed, laden/unladen (km/h)	11/14	11/14	11/14
Lifting speed, laden/unladen (mm/s)	35/40	35/40	35/40
Lowering speed, laden/unladen (mm/s)	35/30	35/30	35/30
Gradeability, laden/unladen (%)	5/12	5/12	5/12
Driving Motor/Lifting Motor/Steering Motor (kw)	AC 4.2/ DC 2.2/ DC 0.15	AC 4.2/ DC 2.2/ DC 0.15	AC 1.5/ DC 2.2/ DC 0.15
Battery (v/Ah)	24/360	24/360	24/360
Controller	Curtis	Curtis	Curtis
Battery Weight (kg)	400	400	400
Service weight with battery (kg)	1120	1045	910

Self-propelled Scissor Truck JWE series

- ▲ New design with larger piston offer you real 1000kg capacity
- ▲ Character: Extremely easy to operate and make this unit very suitable as combined pallet truck and lift table.
- ▲ Automatic descending speed control by a uniquely hydraulic valve, the descending speed always keeps same regardless the truck with or without load. It will prevent cargo damage from fast descending.
- ▲ Ergonomic warm handle offers you simple and comfortable operation.
- ▲ Heavy duty design: 4mm steel plate fork frame and larger lift piston ensure the truck to reach rated capacity.
- ▲ Conforms to EN1757-4.



Model No.	JWE5610	JWE6810
Operation Type	Electric	Electric
Load Capacity (kg/lbs)	1000 (2200)	1000 (2200)
Min. Fork Height (mm/in)	87 (3.4)	87 (3.4)
Max. Fork Height (mm/in)	800 (31.5)	800 (31.5)
Fork/Platform Length (mm/in)	1140 (44.9)	1140 (44.9)
Fork/Platform Width (mm/in)	560 (22)	680 (26.8)
Individual Fork Width (mm/in)	160 (6.3)	160 (6.3)
Load Center (mm/in)	600 (27.6)	600 (27.6)
Front Roller (mm/in)	φ75×75 (φ3×3)	φ75×75 (φ3×3)
Driving Wheel (mm/in)	φ210×70 (φ8.3×2.8)	φ210×70 (φ8.3×2.8)
Overall Length (mm/in)	1707 (67.2)	1620 (63.8)
Overall Width (mm/in)	598 (23.5)	718 (28.3)
Overall Height (mm/in)	1292 (50.9)	1050 (41.3)
Power Unit (W)	0.65	0.65
Battery (V/Ah)	12V/52Ahx2	12V/52Ahx2
Net Weight (kg/lbs)	220 (484)	235 (517)

Portable Pallet Inverters EPD series

- ▲ Can be used as a powered pallet truck.
- ▲ Easily to change a pallet.
- ▲ Conforms to EN1726 and EN1175-1.

Model No.	EPD1012	EPD1515
Load Capacity (kg)	1000	1500
Min. Fork Open (mm)	800	900
Max. Fork Open (mm)	1200	1500
Lowered Height (mm)	85	85
Fork Length (mm)	880	970
Fork Width (mm)	150	150
Turning Radius (mm)	2150	2150
Power Pack	DC 24V/2.0KW	DC 24V/2.0KW
Driving Motor	DC 24V/1.2KW	DC 24V/1.2KW
Battery	210Ah/12x2V	210Ah/12x2V
Driving speed (Laden/unladen) (km/h)	5.1/6.2	5.1/6.2
Overall Size (lowered) (mm)	1980x850x1400	1980x850x1400

