

Chain Hoist MHA series

- The compact and lightweight premium class hand chain hoist.
- Designed for demanding applications.
- Meets or exceeds all industrial standards including EN and ASME/ANSI B30.21 requirements.
- Built-in standard ball bearing ensure easier service than others.
- Two independent pawls give double safety and make fine adjustment possible.
- Highly efficient heat-treated spur gearing provides greater lift with minimum effort.
- Overload protection are available as option.

HOT! SALE

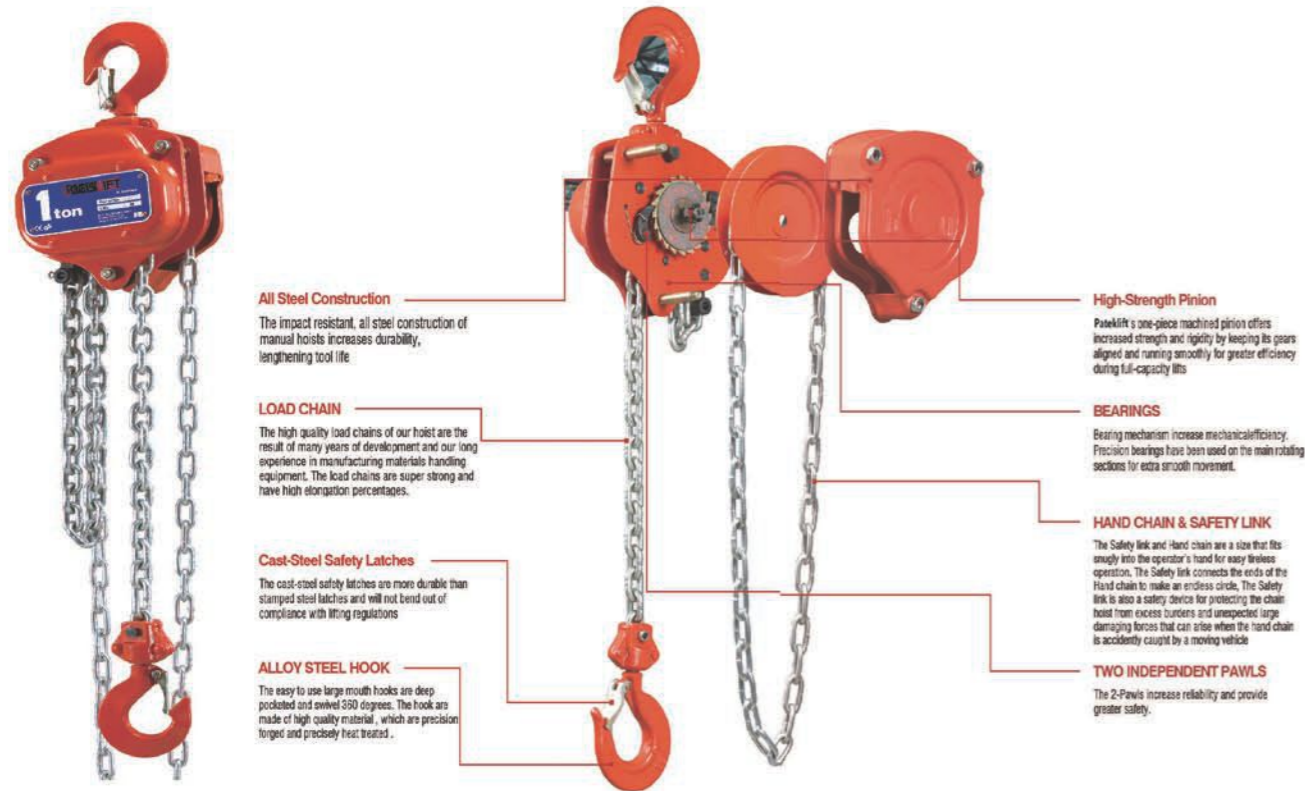

Model No.	MHA05	MHA10	MHA15	MHA20	MHA30	MHA50	MHA100	MHA200	MHA300
Load Capacity (kg)	500	1000	1500	2000	3000	5000	10000	20000	30000
Standard Lifting Height (mm)	2500	2500	2500	3000	3000	3000	3000	3000	3000
Effort to Rated Capacity (N)	262	304	395	330	402	415	428	428x2	442x2
Diameter of Load Chain (mm)	φ5×15	φ6×18	φ8×24	φ8×24	φ8×24	φ10×30	φ10×30	φ10×30	φ10×30
No. of Load Chain Falls	1	1	1	2	2	2	4	8	10
Test Load (kg)	0.75	1.5	2.25	3	4.5	7.5	12.5	25	37.5
Net Weight (kg)	7	11	15	17	23	39	69	162	237
Dimensions A (mm)	135	160	195	160	195	255	395	650	710
Dimensions B (mm)	124	137	143	137	143	173	173	195	298
Dimensions C (mm)	288	334	415	459	536	660	738	1002	1050
Dimensions D (mm)	20	25	35	35	36	46	55	80	82
Dimensions S (mm)	30	37	45	48	50	65	80	105	105
Dimensions T (mm)	11.5	18.5	19	23	27	30	40	60	65
Dimensions U (mm)	18	22	26	29	38	41	61	92	98
Dimensions V (mm)	65	78	97	103	123	150	215	285	285

Chain Hoist MHB series

- Heavy duty and compact design to meet all pertinent world standard.
- Reliable disc brake and premium grade alloy load chain.
- Drop-forged and specially heat treated for great strength and durability.
- **Conforms to CE safety standard.**

HOT! SALE

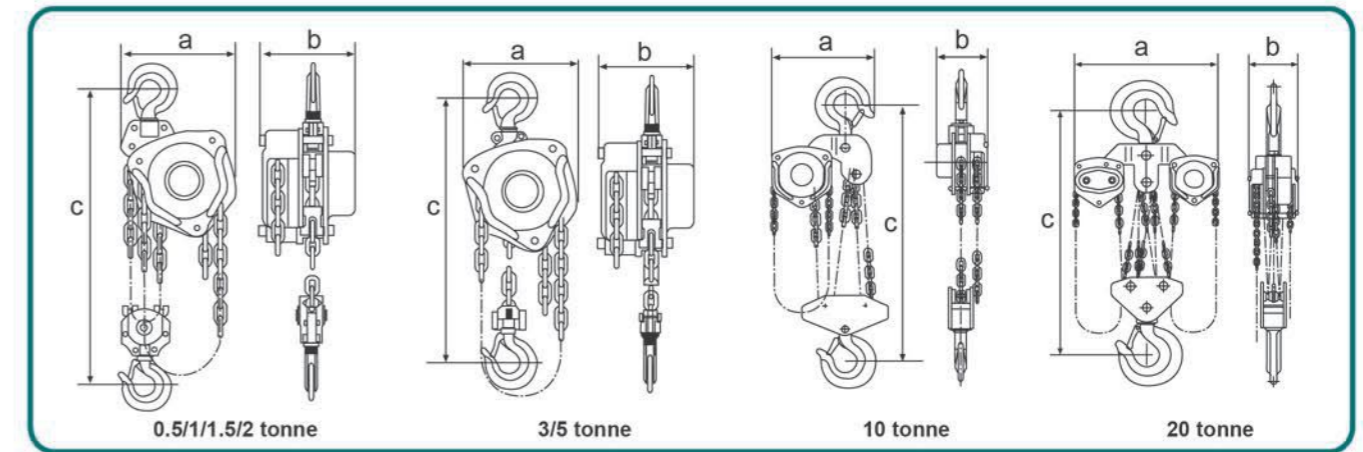
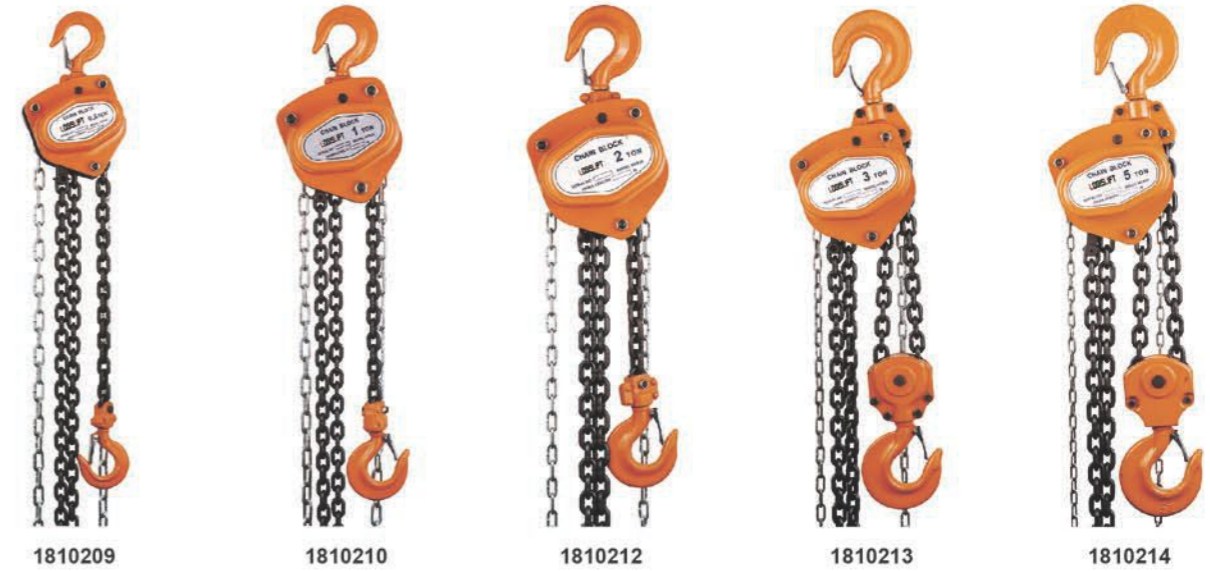

Model No.	MHB05	MHB10	MHB15	MHB20	MHB30	MHB50	MHB100	MHB200
Rated Capacity (tonne)	0.5	1	1.5	2	3	5	10	20
Standard Lifting Height (m)	2.5	2.5	2.5	3	3	3	3	3
Test Load (KN)	6.3	12.5	18.8	25	37.5	75	125	250
Effort to Rated Capacity (N)	231	309	320	360	340	414	414	828
Diameter of Load Chain (mm)	6x18	6x18	8x24	8x24	8x24	10x30	10x30	10x30
No. of Load Chain Falls	1	1	1	1	2	2	4	8
Dimensions	a (mm)	131	140	161	161	186	207	215
	b (mm)	127	158	174	187	199	253	398
	c (mm)	270	317	399	414	465	636	798
Net Weight (kg)	10	12	19	20	27	45.5	83	193
Extra Weight per Meter of Extra Lift (kg)	1.7	1.7	2.3	2.3	3.7	5.6	9.7	19.4

Round-type Chain Hoist HCB series

- Compact design, all steel construction, light handpull.
- Heat treated low-wear, corrosive resistant chain.
- Drop-forged hooks designed to bend slowly to warn of overloads.
- **Conforms to CE safety standard.**

IMPORTANT:
Before installation, see maintenance and operation manual for additional warnings and precautions. Do not use in explosive environment.

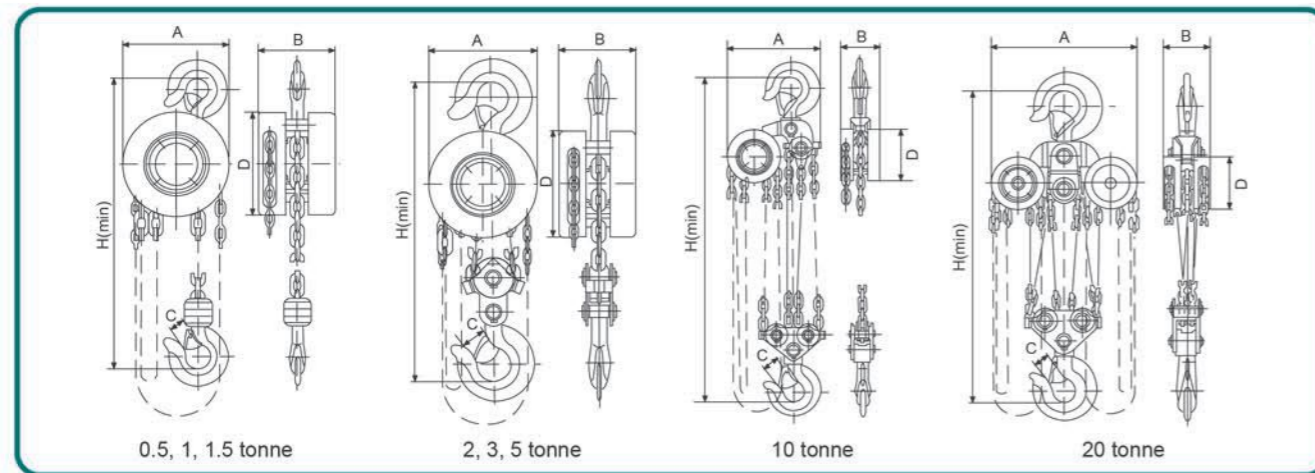

Model No.	HCB05		HCB10		HCB15		HCB20		HCB30		HCB50		HCB100		HCB200	
Rated Capacity (tonne)	0.5		1		1.5		2		3		5		10		20	
Standard Lifting Height (m)	2.5	3	2.5	3	2.5	3	2.5	3	3	5	3	5	3	5	3	5
Test Load (KN)	6.3		12.5		18.8		25		37.5		62.5		125		250	
Effort to Rated Capacity (N)	160		310		360		320		360		400		430		430	
No. of Load Chain Falls	1		1		1		2		2		2		4		8	
Min. Distance between Hooks H (mm)	280		300		360		380		470		600		730		1000	
Diameter of Load Chain (mm)	ø6x18		ø6x18		ø8x24		ø6x18		ø8x24		ø10x30		ø10x30		ø10x30	
Dimensions	A (mm)	142	142	178	142	178	210	358	580							
	B (mm)	130	122	139	122	139	162	162	189							
	C (mm)	24	28	32	34	38	48	62	82							
	D (mm)	142	142	178	142	178	210	358	580							
Net Weight (kg)	9	9.8	9.2	10	14.5	15.3	12	13.5	19.2	21.7	32	35	62	65	140	146
Gross Weight (kg)	9.4	10.2	9.6	10.4	14.9	15.9	12.6	14	19.8	22.3	33	36	64	77	142	172
Extra Weight Per Meter of Extra Lift (pcs)	1.65		1.65		2.3		2.5		3.7		5.2		9.6		19.2	

Note: In addition to the standard lift height, we accept up to 12m lifting height.

Lever Hoist HLB series

- Capacity: from 0.5 up to 9 tonne.
- Unique technology of spring clutch system, holding load at any desired height.
- Light handpull and high efficiency.
- New design drop forged hooks with safer tip and slowly bending performance.
- **Conforms to CE safety standard.**

HOT! SALE

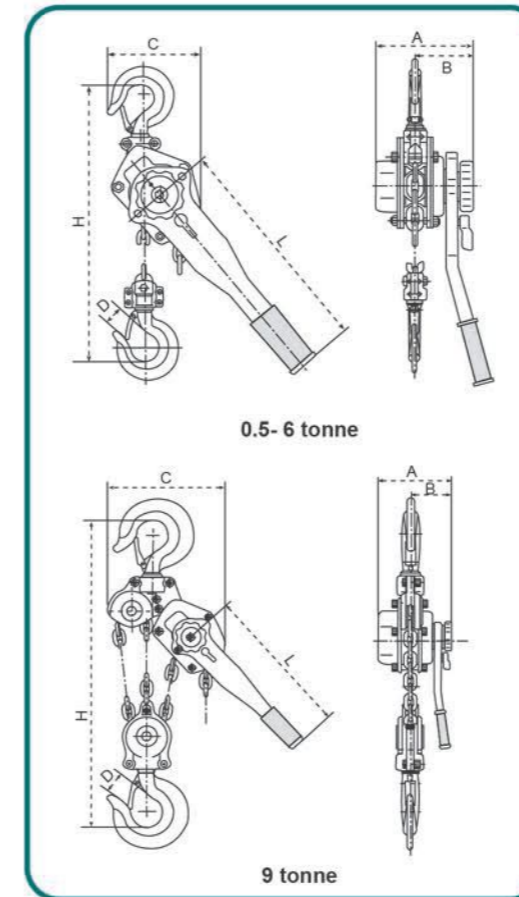

SAFETY INSTRUCTIONS

- * Do not exceed Working Load Limit.
- * Make sure that the end stop is connected to the chain.
- * Keep the load chain lubricated at all times.
- * Before operating, inspect the load chain for damages.
- * Before operating, inspect the upper and lower swivel hooks for signs of deformations and check that the safety latches are attached.
- * Do not lengthen the handle with a pipe in order to exercise greater force.

Model No.	HLB50	HLB75	HLB150	HLB300	HLB600	HLB900
Rated Capacity (tonne)	0.5	0.75	1.5	3	6	9
Standard Lifting Height (m)	1.5	1.5	1.5	1.5	1.5	1.5
Test Load (KN)	6.25	11	22.5	37.5	75	112.5
Effort to Rated Capacity (N)	280	140	220	320	340	360
No. of Load Chain Falls	1	1	1	1	2	3
Diameter of Load Chain (mm)	5	6	8	10	10	10
Dimensions	A (mm)	116	145	175	203	203
	B (mm)	86	86	100	118	118
	C (mm)	115	122	130	150	205
	D (mm)	30	37	45	50	64
	Hmin (mm)	306	320	380	480	620
	L (mm)	280	280	410	410	410
Net Weight (kg)	5	7.5	11.5	21	31.5	47
Extra Weight per Extra Meter of Extra Lift (kg)	0.64	0.8	1.4	2.2	4.4	6.6

Electric Wire Rope MB series

- Conforms to latest European Standard, certified for CE/GS designed with latest European technology.
- Suitable for lifting or unloading goods in shops, restaurant, industry assembly lines and food industry.
- Also a useful tool to lifting materials and different goods in house or apartment.
- With urgent stop switch and reinforced breaking switch with position limit, protection class up to IP54, with thermal prevention device.

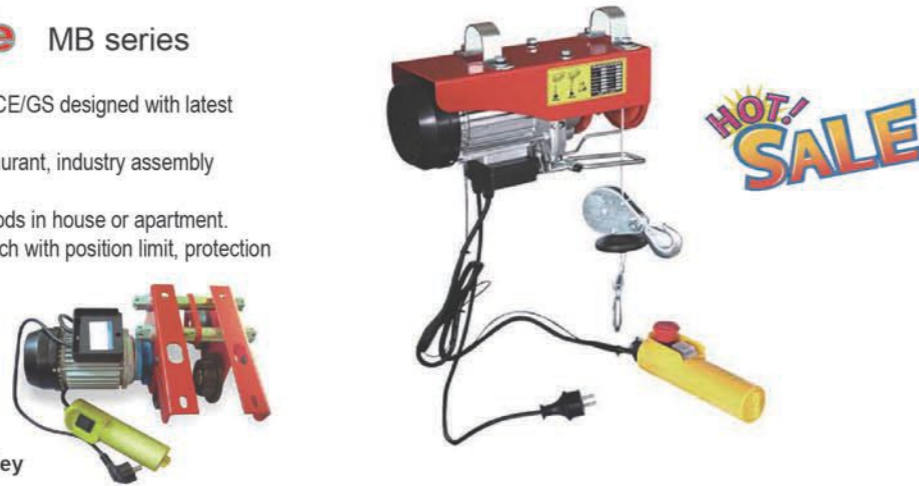

Optional Electric Trolley

Model No.	MB200A		MB250A		MB300A		MB400A		MB500A		MB600A	
No. of wire	Single	Double	Single	Double	Single	Double	Single	Double	Single	Double	Single	Double
Use of Hook Rated Voltage (V)	220/230/50HZ/1P or 220/230/60HZ/1P											
Input Power (W)	510				600		980		1020		1200	
Lifting Cap. (kg)	100	200	125	250	150	300	200	400	250	500	300	600
Lifting Speed (m/min)	10	5	10	5	10	5	10	5	10	5	10	5
Lifting Height (m)	12	6	12	6	12	6	12	6	12	6	12	6
G.W./N.W. (kg/2pcs)	24/22						35/33					

Model No.	MB700A		MB800A		MB1000A		MB1200A		MB200B		MB400B	
No. of wire	Single	Double	Single	Double	Single	Double	Single	Double	Single	Double	Single	Double
Use of Hook Rated Voltage (V)	220/230/50HZ/1P or 220/230/60HZ/1P										110	
Input Power (W)	1250				1600		1800		510		980	
Lifting Cap. (kg)	350	700	400	800	500	1000	600	1200	100	200	200	400
Lifting Speed (m/min)	8	4	8	4	8	4	8	4	8	4	8	4
Lifting Height (m)	12	6	12	6	12	6	12	6	12	6	12	6
G.W./N.W. (kg/2pcs)	39/37				33/32		34/33		24/22		35/33	

Rotary Hoist Frame

- Conforms to CE safety standard.

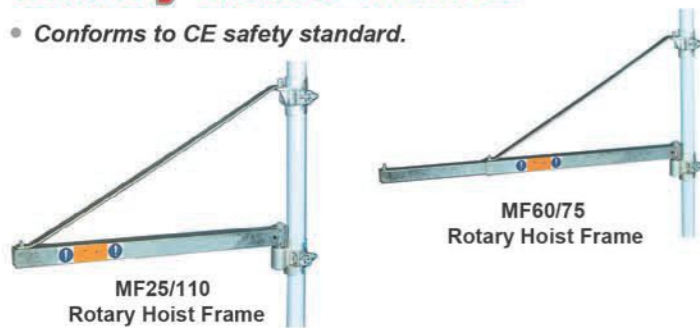

Model No.	MF25/110	MF60/75
Capacity (kg)	250	600
Max. Length (mm)	1100	750
G.W./N.W. (kg)	49/48	38/37

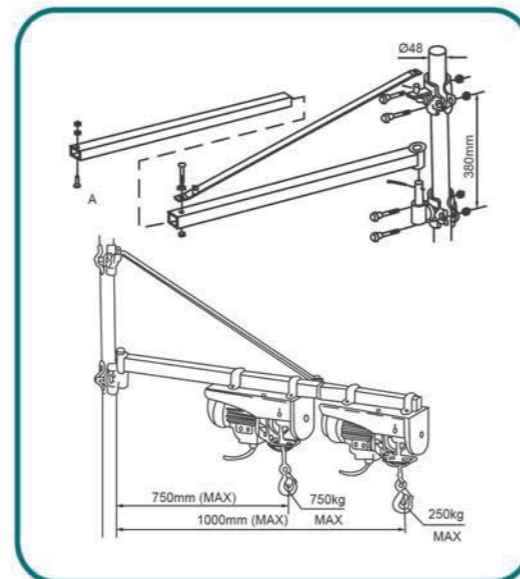

Electric Wire Rope NB series

The mini hoist can be widely used in hanging for engineering, plant hoist operations, civil hydropower installed piping, Warehousing and shipping the goods; it can be used to lift, raise and, drag. It's compact, lightweight, economy and effective, and easy to obtain single-phase power supply.

SPECIAL FEATURES:

- **Motor system:** Using brush less motor series excited of high efficiency industrial grade; there are two selected configurations of single-phase voltage (110V/220V); its enameled heat levels up to 200 degrees, specifically designed for long crane.
 - **Brakesystem:** Dual brake system with one mechanical ratchet gear brakes and the other brake resistor short circuit controller; formula oiled copper disc brakes with high friction coefficient, which needs no adjustment; immediately brake in power outage or malfunction, great safety and long life.
 - **Seomfysystems:** Cable stops automatically over the volume limit; cable stops automatically when inverting.
 - **Electronic control system:** Direct control which saves tedious lines and has the advantages of easy maintenance, low failure rate, security and stability; control switch with separate power line and quick connector makes it easy to carry.
 - **Cable Specifications:** Japan imported steel wire from large manufacturing firms with 3-fold safety factor.
 - **Gearsystem:** Use drive bevel reducing gear of high efficiency; heat treated alloy steel gear with its intensity three times higher than the rated hoist.
- PART OF THE MAIN BODY CASE:** Die-casted in one piece, motor body and gearbox have the advantages of strong toughness, computer CNC machining, high precision, low noise, and smooth operation; using automotive-grade powder coating, it has nice appearance; it's compacted and light-weighted.



Model No.	NB160	NB180	NB230	NB250	NB300	NB280	NB360	NB500
Rated Capacity (kg)	160	180	230	250	300	280	360	500
Standard Lifting Height (m)	28	28	28	28	28	58	58	30
Voltage (V)	100-120V/200-240V all available							
Phase	single	single	single	single	single	single	single	single
Wire Rope Dia. (mm)	5	5	5	5	5	5	5	5
Lifting Speed/50HZ (m/min.)	19	19	19	19	19	12	12	13
Lifting Speed/60HZ (m/min.)	23	23	23	23	23	16	16	17
Motor (kw)	1.2	1.3	1.3	1.5	1.5	1.3	1.5	1.6

Electric Chain Hoist with Trolley SG series

- ▲ Shell: Light aluminum alloy shell be adopted, which is hard and used in the terrible work environment.
- ▲ Inverse phase sequence protecting device: Special electrical installation which controls the circuit not work in case of wiring error in the power supply.
- ▲ Limit switch: The limit switch is installed where the weight is lifted on and off to stop the motor automatically, avoid any exceed, with safety.
- ▲ Side magnetic braking system.
- ▲ Light weight and durable chain bag.
- ▲ G80 ultra heat-treated alloy chain.



Electric Chain Hoist - 380V/50HZ/3P

Model No.	Capacity (Ton)	Lifting Height (m)	Lifting Speed (m/min.)	Power (kw)	Rotation Speed (r/min.)	Chain
SG05-1	0.5	3/9	7.2	1.1	1440	Φ6.3
SG10-1	1	3/9	6.8	1.5	1440	Φ7.1
SG10-2	1	3/9	3.6	1.1	1440	Φ6.3
SG15-1	1.5	3/9	8.8	3.0	1440	Φ10.0
SG20-1	2	3/9	6.6	3.0	1440	Φ10.0
SG20-2	2	3/9	3.4	1.5	1440	Φ7.1
SG25-1	2.5	3/9	5.6	3.0	1440	Φ11.2
SG30-1	3	3/9	5.6	3.0	1440	Φ11.2
SG30-2	3	3/9	4.4	3.0	1440	Φ10.0
SG30-3	3	3/9	2.2	1.0	1440	Φ7.1
SG50-2	5	3/9	2.8	3.0	1440	Φ11.2
SG75-3	7.5	3/9	1.8	3.0	1440	Φ11.2
SG100-4	10	3/9	2.8	3.0x2	1440	Φ11.2
SG150-6	15	3/9	1.8	3.0x2	1440	Φ11.2
SG200-8	20	3/9	1.4	3.0x2	1440	Φ11.2
SG250-10	25	3/9	1.1	3.0x2	1440	Φ11.2

Electric Chain Hoist with Trolley

Model No.	Capacity (Ton)	Lifting Height (m)	Driving Motor			I-Beam (mm)	Chain Falls	Weight (kg)
			Driving Speed (m/min.)	Power (kw)	Rotation Speed (r/min.)			
SGD05-1	0.5	3/9	11/1,21/1	0.4	1440	75-125	1	89
SGD10-1	1	3/9	11/1,21/1	0.4	1440	68-153	1	103
SGD10-2	1	3/9	11/1,21/1	0.4	1440	68-153	2	101
SGD15-1	1.5	3/9	11/1,21/1	0.4	1440	82-178	1	157
SGD20-1	2	3/9	11/1,21/1	0.4	1440	82-178	1	164
SGD20-2	2	3/9	11/1,21/1	0.75	1440	82-178	2	122
SGD25-1	2.5	3/9	11/1,21/1	0.75	1440	100-178	1	177
SGD30-1	3	3/9	11/1,21/1	0.75	1440	100-178	1	183
SGD30-2	3	3/9	11/1,21/1	0.75	1440	100-178	2	192
SGD30-3	3	3/9	11/1,21/1	0.75	1440	100-178	3	146
SGD50-2	5	3/9	11/1,21/1	0.75	1440	112-178	2	234
SGD75-3	7.5	3/9	11/1,21/1	0.75	1440	112-178	3	214
SGD100-4	10	3/9	11/1,21/1	0.75	1440	150-220	4	440
SGD150-6	15	3/9	11/1,21/1	0.75x2	1440	150-220	6	360
SGD200-8	20	3/9	11/1,21/1	0.75x2	1440	150-220	8	460
SGD250-10	25	3/9	11/1,21/1	0.75x2	1440	150-220	10	560

Electric Wire Rope with Trolley CD/MD series

- ▲ CD series electric hoist is an improvement electric hoist that is completely resolved the problem of that the electric hoist reaches the up limited position, guide rope device is embrittlement cracking, the wire rope is disorder, the reducer is losing oil, the frequent trouble about electric and so on.
- ▲ Adopting heavy punch to limited the position, it has simple structure, reliable movement which can prevent the phenomenon of the electric hoist reaches the limited position that caused by the chock block in gag lever post to side down the unreliable movement of the spark out limited position and so many factors
- ▲ To prevent the disorder of the guide rope device, also can prevent the phenomenon of the wire rope wind disorder that appeared in the process of going up and going down. It can make sure that under the circumstance lack of hanger hook acting force, the wire rope can pass through the hole in the rope device regularly, The guide rope nut use whole to bisection structure, the spring can adjust the degree of tightness automatically, it is endurable.

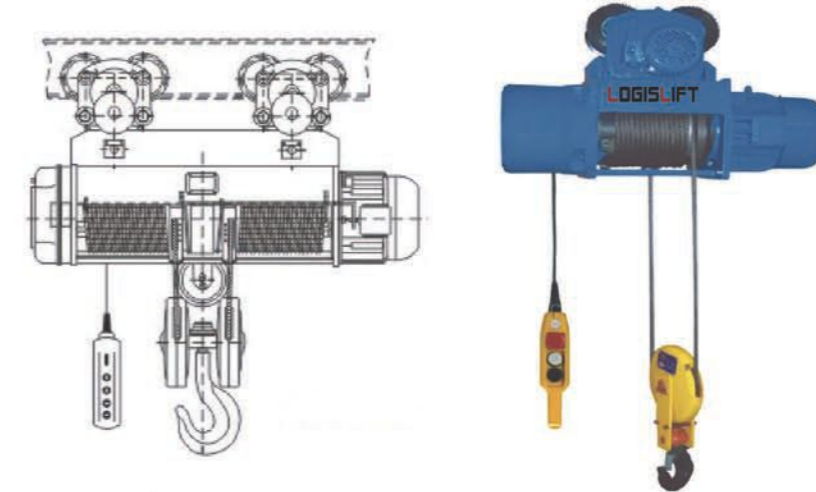

ITEM		CD, MD																	
		0.25			0.5			1			2								
Lifting Capacity	Ton																		
Lifting Height	M	3	6	9	3	6	9	6	9	12	18	24	30	6	9	12	18	24	30
Lifting Speed	m/min	8(8/0.8)			8(8/0.8)			8(8/0.8)			8(8/0.8)								
Travel Speed	m/min	20(30)			20(30)			20(30)			20(30)								
Wire Rope	Diameter of rope	3.6			4.8			7.4			11								
	Diameter of wire				0.22			0.34			0.5								
	Structure form	6*19			D-6*19-4.8			D-6*37-7.4			D-6*37-11								
Lifting Motor	Type	ZD112-4			ZD112-4 ZDS1 0.2/0.8			ZD122-4 ZDS1 0.2/1.5			ZD131-4 ZDS1 0.4/3								
	Capacity/kw	0.4			0.8 0.2/0.8			1.5 0.2/1.5			3 0.4/3								
	Rotating speed/r/min	1380			1380			1380			1380								
	Power							3P (380v-660V) 50Hz. 60Hz											
Traveling Motor	Type	Dw 5024			ZDY 111-4			ZDY 111-4			ZDY 112-4								
	Capacity/kw	0.06			0.2			0.2			0.4								
	Rotating speed/r/min	1400			1380			1380			1380								
	Power							3P (380v-660V) 50Hz. 60Hz											
I-Beam	mm	16-28b			16-28b			20a-32c			20a-32c								

ITEM		CD, MD																	
		3					5					10							
Lifting Capacity	Ton																		
Lifting Height	M	6	9	12	18	24	30	6	9	12	18	24	30	6	9	12	18	24	30
Lifting Speed	m/min	8(8/0.8)					8(8/0.8)					8(8/0.8)							
Travel Speed	m/min	20(30)					20(30)					20(30)							
Wire Rope	Diameter of rope	13					13					13							
	Diameter of wire	0.6					0.6					0.6							
	Structure form	D-6*37-13					D-6*37-15					D-6*37-15							
Lifting motor	Type	ZD132-4 ZDS1 0.4/4.5					ZD132-4 ZDS1 0.4/4.5					ZD132-4 ZDS1 0.4/4.5							
	Capacity/kw	4.5 0.4/4.5					4.5 0.4/4.5					4.5 0.4/4.5							
	Rotating speed/r/min	1380					1380					1380							
	power						3P (380v-660V) 50Hz. 60Hz												
Traveling Motor	Type	ZDY 112-4					ZDY 112-4					ZDY 112-4							
	Capacity/kw	0.4					0.4					0.4							
	Rotating speed/r/min	1380					1380					1380							
	Power						3P (380v-660V) 50Hz. 60Hz												
I-Beam	mm	20a-32c					20a-63c					20a-63c							

Electric Chain Hoist XG series

- ▲ Conforms to latest European Standard, certified for CE/GS designed with latest European technology.
- ▲ This organic adopts die-casting aluminium principle, legerity and agility, up and down position limit protection, phase protection and electromagnetic brake.



Model No.		XG250-380	XG500-380	XG250-230	XG500-230
Rated Capacity	(kg)	250	500	250	500
Lifting Height	(m)	3	3	3	3
Rated volt	(V)	AC 380V/50-60HZ/3P		AC 230V/50-60HZ/1P	
Chain Size	(mm)	Φ 5x15	Φ 5x15	Φ 5x15	Φ 5x15
Motor	(kw)	0.4	0.4	0.4	0.4
Lifting Speed	(m/min.)	8	4	8	4
Work Rate		S3-30% 20min.			
Packing size	(mm)	490x210x290			
Net Weight	(kg)	23	25	23	25

Electric Chain Hoist XG series

- ▲ Conforms to latest European Standard, certified for CE/GS designed with latest European technology.
- ▲ This organic adopts die-casting aluminium principle, legerity and agility, up and down position limit protection, phase protection and electromagnetic brake.



Model No.		XG500-1P	XG1000-1P	XG1000-3P	XG2000-3P
Rated Capacity	(kg)	500	1000	1000	2000
Lifting Height	(m)	3	3	3	3
Rated volt	(V)	AC 100/110/120/220/230/240V/ 50-60HZ/1P		AC 230/380/420/440V/50-60HZ/3P	
Chain Size	(mm)	Φ 8x24	Φ 8x24	Φ 8x24	Φ 8x24
Motor	(kw)	0.65	0.65	1.1	1.1
Handle control	(V)	24	24	24	24
Lifting Speed	(m/min.)	5	2.5	5	2.5
Work Rate		S3-30% 20min.			
Packing size	(mm)	650x370x540			
Net Weight	(kg)	43	54	43	56

Gantry Crane MD series (without hoist)

- ▲ Conforms to latest European Standard, certified for CE/GS designed with latest European technology.
- ▲ This organic adopts die-casting aluminium principle, legerity and agility, up and down position limit protection, phase protection and electromagnetic brake.



Model No.	Capacity(kg)	Span(mm)	Height(mm)	Type
MD2525-05	500	2500	2500	Fixed Height
MD2530-05	500	2500	3000	Fixed Height
MD3025-05	500	3000	2500	Fixed Height
MD3030-05	500	3000	3000	Fixed Height
MD3035-05	500	3000	3500	Fixed Height
MD3530-05	500	3500	3000	Fixed Height
MD4030-05	500	4000	3000	Fixed Height
MD4040-05	500	4000	4000	Fixed Height
MD4050-05	500	4000	5000	Fixed Height
MD2525-10	1000	2500	2500	Fixed Height
MD2530-10	1000	2500	3000	Fixed Height
MD3025-10	1000	3000	2500	Fixed Height
MD3030-10	1000	3000	3000	Fixed Height
MD3530-10	1000	3500	3000	Fixed Height
MD4030-10	1000	4000	3000	Fixed Height
MD4040-10	1000	4000	4000	Fixed Height
MD4045-10	1000	4000	4500	Fixed Height
MD4050-10	1000	4000	5000	Fixed Height
MD2525-20	2000	2500	2500	Fixed Height
MD2530-20	2000	2500	3000	Fixed Height
MD3030-20	2000	3000	3000	Fixed Height
MD3530-20	2000	3500	3000	Fixed Height
MD4030-20	2000	4000	3000	Fixed Height
MDS2530-05	500	2500	2000-3000	Adjustable Height
MDS2540-05	500	2500	3000-4000	Adjustable Height
MDS3030-05	500	3000	2000-3000	Adjustable Height
MDS3040-05	500	3000	3000-4000	Adjustable Height
MDS4030-05	500	4000	2000-3000	Adjustable Height
MDS4040-05	500	4000	3000-4000	Adjustable Height
MDS2530-10	1000	2500	2000-3000	Adjustable Height
MDS2540-10	1000	2500	3000-4000	Adjustable Height
MDS3030-10	1000	3000	2000-3000	Adjustable Height
MDS3040-10	1000	3000	3000-4000	Adjustable Height
MDS4030-10	1000	4000	2000-3000	Adjustable Height
MDS4040-10	1000	4000	3000-4000	Adjustable Height
MDS2530-20	2000	2500	2000-3000	Adjustable Height
MDS2540-20	2000	2500	3000-4000	Adjustable Height
MDS3030-20	2000	3000	2000-3000	Adjustable Height
MDS3040-20	2000	3000	3000-4000	Adjustable Height
MDS4030-20	2000	4000	2000-3000	Adjustable Height
MDS4035-20	2000	4000	2500-3500	Adjustable Height
MDS4040-20	2000	4000	3000-4000	Adjustable Height

Gantry Crane LGC series (without hoist)

- ▲ Conforms to latest European Standard, certified for CE/GS designed with latest European technology.
- ▲ This organic adopts die-casting aluminium principle, legerity and agility, up and down position limit protection, phase protection and electromagnetic brake.



Model No.		LGC05	LGC10	LGC20
Load Capacity	(kg/lbs)	500/1100	1000/2200	2000/4400
Beam Size	(mm)	100x68x2200	120x74x2200	160x88x2200
Min. Beam Height C	(mm/in)	2420/9.5	2400/9.45	2400/9.45
Max. Beam Height E	(mm/in)	3620/14.2	3600/14.1	3600/14.1
Span width A	(mm/in)	2400/9.45	2400/9.45	2400/9.45
Overall Dimensions B*F*D	(mm)	3130x1200x2525	3120x1200x2515	3120x1200x2555
Adjustable Position		12	12	12
Adjustable Height per position	(mm)	100	100	100
Wheels	(mm)	PU/100mm	PU/125mm	PU/125mm
Net Weight	(kg/lbs)	110/242	130/286	170/374

Counter-balanced Crane LEC series

- ▲ Larger capacity than normal shop cranes at 5 positions.
- ▲ Chrome plated lifting piston and pump piston.
- ▲ Relief valve to prevent overload.
- ▲ 360° swivel operating crane.
- ▲ Forged heavy duty swivel hook.
- ▲ 125% overload testing before delivery.
- ▲ Conforms to CE safety standard.



Model No.	Max.Capacity (kg)	Max.Lifting Height (mm) / Load capacity (kg)				
		P1	P2	P3	P4	P5
LEC550	550	1900/550	2160/450	2260/350	2450/250	2600/150

Foldable Shop Crane ZDA series

- ▲ Space saver fold compact design.
- ▲ Release valve on hydraulic ram allows controlled lowering.
- ▲ With 4 positions for loading capacity 1-2ton.
- ▲ With 1 position for loading capacity 3ton.
- ▲ 2 Swivel castors, 2 fixed castors.
- ▲ **Conforms to CE safety standard.**



Model No.	Load capacity (kg)	Lifting Range (mm)	Net Weight (kg)
ZDA1000	1000	0-2000	68
ZDA2000	2000	0-2000	90
ZDA3000	3000	0-2000	125

Pick-up Crane ZDC series



Model No.		ZDC101A	ZDC102A	ZDC101B	ZDC102B
Load Capacity	(kg)	500	1000	500	1000
Lifting Height	(mm)	0-2000	0-2000	0-2000	0-2000
Net Weight	(kg)	48	50	52	66

Euro Shop Crane SA series

- ▲ Heavy duty design.
- ▲ Suitable for European pallet.
- ▲ Chrome plated lifting piston.
- ▲ **Conforms to CE safety standard.**

Model	SA500	SA1000
Capacity	500	1000
Position 1	500	1000
Position 2	450	900
Position 3	400	800
Position 4	350	700
Net Weight	81	103
L1	1360	
L2	1060	
L3	1395	
H1	155	
H2	570	
H3	750	
H4	1980	
H5	2150	
H	1595	
B1	965	
B2	840	
B3	1000	

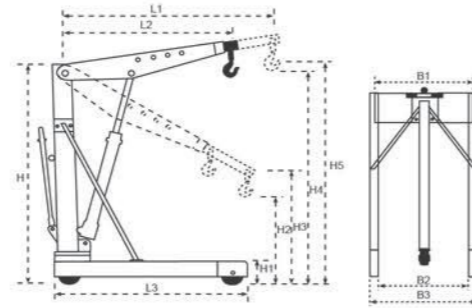

Rotary Crane LZ series

- ▲ Fixed with anchor bolt.
- ▲ Save labor and space for operation.



Model	LZ12	LZ25	LZ50
Max. Capacity (kg)	125	250	500
Lifting Height (mm)		3000-4500	
Arm length (mm)		2500-4000	

Foldable Shop Crane SC series

- ▲ Larger capacity than normal shop cranes at 3 positions.
- ▲ Chrome plated lifting piston and pump piston.
- ▲ Relief valve to prevent overload.
- ▲ 360° swivel operating handle.
- ▲ Forged heavy duty swivel hook.
- ▲ 125% overload testing before delivery.
- ▲ **Conforms to CE safety standard.**



New deadmen lowering system!

HOT! SALE



Model	SC500A	SC1000A	SC2000A
Capacity at Position (kg)	P1	500	1000
	P2	425	800
	P3	350	700
Dimensions (mm)	A	1354	1597
	B	165	90
	C	1582	1749
	D	897	1231
	E	102	150
	F	2080	2450
	G	1920	2320
	H	130	
	I	330	280
Overall Width (mm)	960	1100	1170
Net Weight (kg)	75	115	165

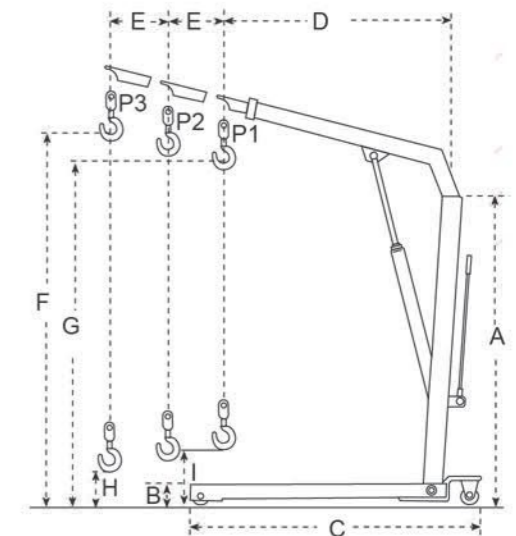

Counter-Balanced Crane SD / SDD series

- ▲ Counter balanced shop crane.
- ▲ Unique operate handle, brake design, mobile and foldable.
- ▲ With double action hydraulic pump, fast and easy.
- ▲ Allows to work close to a machine.
- ▲ Tested 25% overload before delivery.

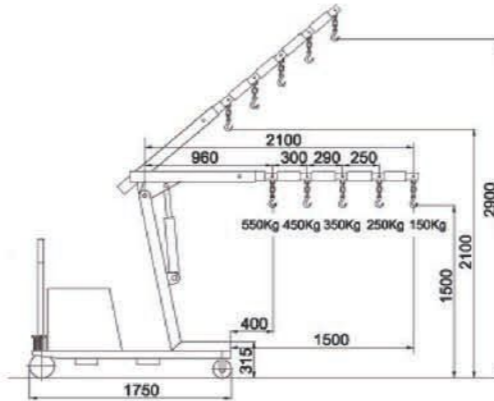

SD model manual type



SDD model Semi-Electric type



Full-Electric Type

Model No.	SD550	SD750	SDD550	SDD750
Load Capacity (kg)	550	750	550	750
Max load at jib length 925 (kg)	550	750	550	750
Max load at jib length 1210 (kg)	450	500	450	500
Max load at jib length 1500 (kg)	350	380	350	380
Max load at jib length 1800 (kg)	250	260	250	260
Max load at jib length 2080 (kg)	150	200	150	200
Hydraulic Pump	quick 1000(kg)	quick 1000(kg)	Electric	Electric
Wheel (mm)	PU or Nylon, φ180	PU or Nylon, φ180	PU or Nylon, φ180	PU or Nylon, φ180
Max. crane arm length (mm)	2080	2080	2080	2080
Min. crane arm length (mm)	930	930	930	930
Lifting height max. cantilever arm extended (mm)	2750	2750	2750	2750
Overall Size LxWxH (mm)	2400x910x1630	2400x910x1630	2400x910x1630	2400x910x1630
Packing Size LxWxH(2pcs) (mm)	2400x1900x1700	2400x1900x1700	2400x1900x1700	2400x1900x1700
Weight (without counterweight & box) (kg)	180	180	215	220
Weight of counterweight box (kg)	210+30	280+40	210+30	280+40
Total Weight(with counterweight&box) (kg)	420	470	455	540
Battery (V/Ah)	-	-	12/60	12/80
Charger (V/A)	-	-	12/8	12/8

Crane Fork CK / CY / CC series

- ▲ No slings or chains necessary.
- ▲ Crane operator will not need to leave cab of lorry or crane.
- ▲ Forks will remain horizontal when loaded and unloaded.
- ▲ Adjustable fork width.
- ▲ Adjustable height.



CK 30



CK Series Manual balancing



CY 30



CY Series Self-balancing head

Model	CK10	CK20	CK30	CK50
Work Load Limit WLL (tonne)	1	2	3	5
Adjustable Fork Width b (mm)	350-900	400-900	450-900	530-1000
Hook Height h1 (mm)	1390-1890	1640-2340	1670-2370	1700-2400
Effective Height h (mm)	1100-1600	1300-2000		
Fork Length L (mm)	1000			
Fork Cross D (mm)	100x30	120x40	120x50	150x60
Overall Size LxWxH (mm)	1120x920x1390	1140x920x1640	1140x920x1670	1140x920x1670
Net Weight (kg)	130	200	250	370

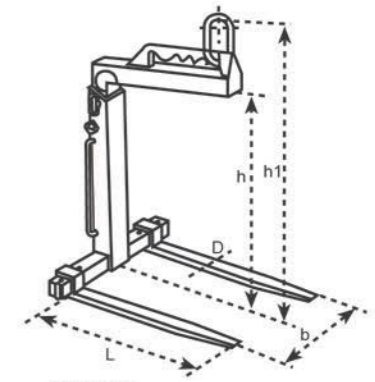

CK Series

Model	CY10	CY20	CY30	CY50
Work Load Limit WLL (tonne)	1	2	3	5
Adjustable Fork Width b (mm)	350-900	400-900	450-900	530-1000
Hook Height h1 (mm)	1420-1920	1655-2355	1720-2420	1710-2410
Effective Height h (mm)	1100-1600	1300-2000		
Fork Length L (mm)	1000			
Fork Cross D (mm)	100x30	120x40	120x50	150x60
Overall Size LxWxH (mm)	1120x920x1530	1140x920x1775	1140x920x1850	1160x1020x1850
Net Weight (kg)	140	220	280	380

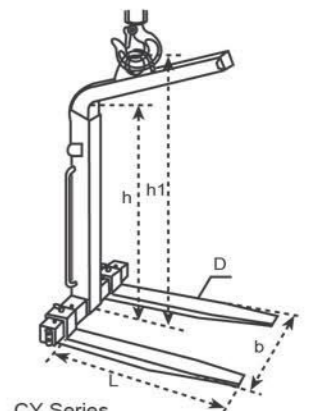

CY Series

Model No.	CC10	CC15	CC20	
Load Capacity WLL (t)	1	1.5	2	
Dimensions	A min/max (mm)	320/1500	320/1500	320/1500
	B (mm)	1000	1000	1000
	C min/max (mm)	1150/1380	1150/1380	1150/1380
	D min/max (mm)	500/715	500/715	650/890
Net Weight (kg)	115	120	145	



Trolley Clamp TC series

- The easy installation to any beam makes it suitable for fixing to any moving hoist, pulleys and loads.
- It can be adjusted quickly to the beam width by turning the main spindle.
- Safety is ensured by the special locking lever.
- The spindle and snap-pin stops are galvanized to protect against corrosion.
- **Conforms to CE safety standard.**



TC20A

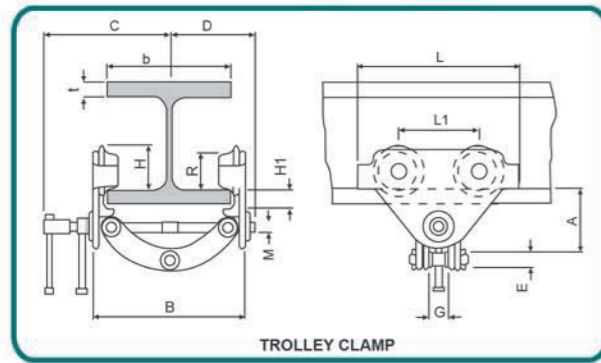

Model No.	TC01A	TC20A	TC20B	TC30A	TC30B
Capacity (kg)	1000	2000		3000	
Flange Width b (mm)	61-151	74-200	199-300	75-200	200-320
A	81-108	89-154	135-190	128-171	150-212
G	26	42		50	
E	22	20		22	
H1	20	30		30.5	
H	53	71.5		95.5	
L	160	260		310	
L1	75	130		150	
M	M12	M18		M24	
R	46	60		80	
C	153	205	255	220	280
D	105	139	189	155	215
t max	15		25		
Net Weight (kg)	2.5	9.9	10.3	17.5	19.5

Plain Trolley 0.5-10T MTA series

Professional class

- Double sealed ball bearings.
- Built-in bumper guards.
- Adjustable to fit various sizes of flange and I-beams.
- Use on straight or curved track.
- Can be installed or removed at any point along the track.
- **Conforms to CE safety standard.**
- **Conforms to ANSI/ASME safety standard.**

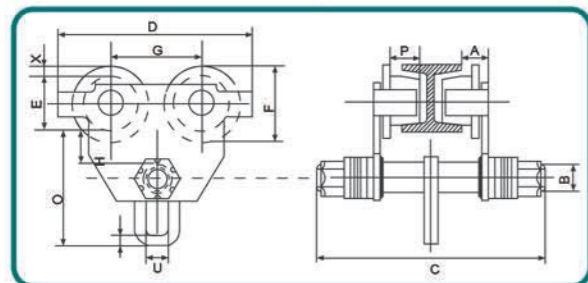

Model	MTA05	MTA10	MTA20	MTA30	MTA50	MTA100	
Capacity (kg)	500	1000	2000	3000	5000	10000	
Beam Flange Width b (mm)	64-140		76-165	76-203	88-203	125-203	
Dimensions (mm)	O	128	143	172	212	254	320
	A	22	25	27	31	36	46
	B ø	24	30	36	42	48	60
	C	230	254	294	344	360	403
	D	212	255	302	344	378	445
	E ø	58	75	90	110	122	151
	F	82	102	122	142	156	188
	G	102	118	137	157	172	200
	H	28	25	27	32	34	35
	T ø	44	50	60	78	90	94
	R	6	8	10	12	16	25
	S	95	118	145	180	220	285
	L	15	20	26	35	45	
	X	12	13.5	16	17	18	
P	26	28	34	38	44	48	
N	10	12	14	16	20	25	
U	24	30.5	36	45	60	82	
Net Weight (kg)	7	12	22	30	55	93	

Geared Trolley 0.5-20T MTB series

Professional class

- Double sealed ball bearings.
- Built-in bumper guards.
- Adjustable to fit various sizes of flange and I-beams.
- Use on straight or curved track.
- Can be installed or removed at any point along the track.
- **Conforms to CE safety standard.**
- **Conforms to ANSI/ASME safety standard.**



Dimensions (mm)

Model	MTB05	MTB10	MTB20	MTB30	MTB50	MTB100	MTB200	
Capacity (kg)	500	1000	2000	3000	5000	10000	20000	
Beam Flange Width b (mm)	64-140		76-165	76-203	88-203	125-203	144-203	
Dimensions (mm)	O	128	143	172	212	254	320	385
	A	22	25	27	31	36	46	68
	B ø	24	30	36	42	48	60	
	C	230	254	294	344	360	403	475
	D	212	255	302	344	378	445	642
	E ø	58	75	90	110	122	151	200
	F	82	102	122	142	156	188	274
	G	102	118	137	157	172	200	300
	H	28	25	27	32	34	35	55
	T ø	44	50	60	78	90	94	
	R	6	8	10	12	16	25	30
	S	95	118	145	180	220	285	302
	L	15	20	26	35	45	70	
	X	12	13.5	16	17	18	37	
P	26	28	34	38	44	48	60	
N	10	12	14	16	20	25	35	
U	24	30.5	36	45	60	82	110	
I	113.5	112.5	135	136	160	151.5		
Net Weight (kg)	14	19	28	40	65	103	245	

Warning: Don't use in explosive environment.
Note: Customer's specification or OEM is acceptable.

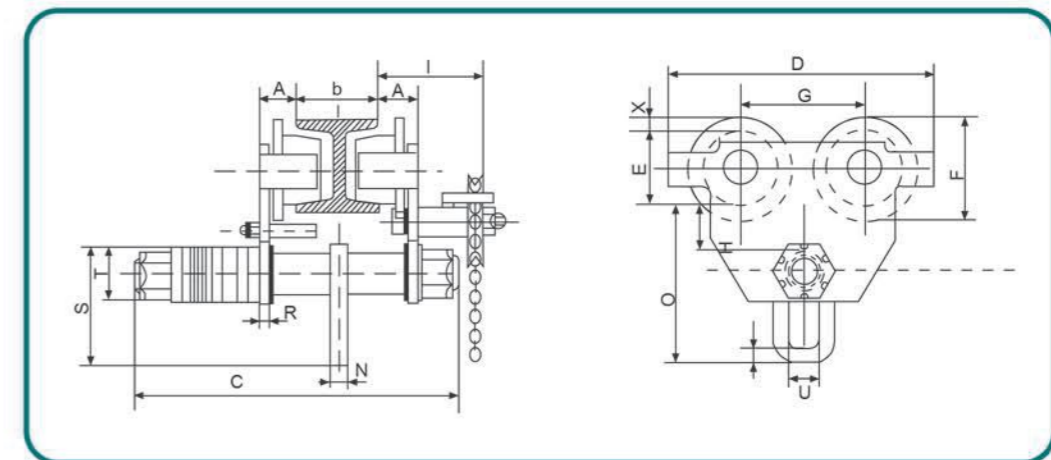

Plain Trolley PT series

- Adapts to wide range of beam adjustment by thread.
- Versatile trolley for use with any hook suspended hoist.
- **Conforms to CE safety standard.**

Warning:

The equipment shown is only intended for industrial use. Should not be used to lift, support, transport people, or to suspend loads over people.

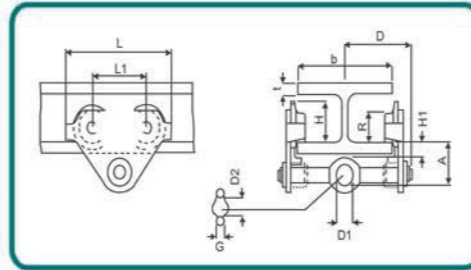

Model	PT05-A	PT05-B	PT10-A	PT10-B	PT20-A	PT20-B	PT30-A	PT30-B	PT50-A	PT50-B
Capacity (kg)	500		1000		2000		3000		5000	
Beam Flange Width b (mm)	50-203	160-300	50-203	160-300	66-203	160-300	74-200	160-300	90-203	180-300
Beam Flange Thickness t (mm)	25	40	25	40	25	40	25	40	25	40
A	77	92	82.5	97.5	98.5	113.5	114	129	132.5	147.5
G	16		17		22		26		33	
D1	25		30		40		48		60	
D2	30		35		47		58		70	
H	71.5				95.5		131		142.5	
H1	30.5	45.5	30.5	45.5	30.5	45.5	30	45	30	45
L	260				310		390		450	
L1	130				150		180		209	
R	60				80		112		125	
D	146	187	150	187	155	189.5	160	191.5	167.5	191.5
Net Weight (kg)	8.0	10.6	9.0	12	16	19.3	32	35.8	48	52.2

Geared Trolley PTG series

- Very easy to adjust the width to fit different beam by thread.
- Cast iron universal tread wheels for use on flat or tapered flange beams.
- Sealed "Lube for Life" ball bearings.
- Wheel adjustments will fit most I.S.W and I-beams or patented track.
- Effective for precise spotting jobs.
- Equipped with 3m drop chain.
- **Conforms to CE safety standard.**

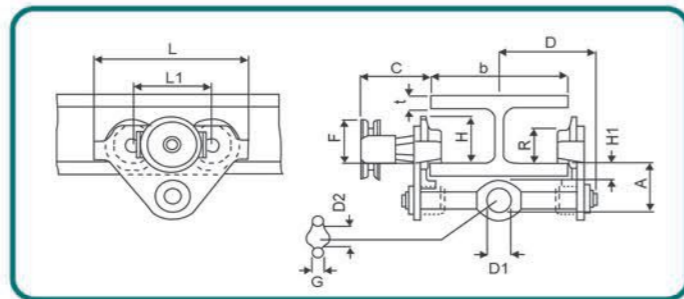

Model	PTG05A	PTG05B	PTG10A	PTG10B	PTG20A	PTG20B	PTG30A	PTG30B	PTG50A	PTG50B
Capacity (kg)	500		1000		2000		3000		5000	
Beam Flange Width b (mm)	50-203	160-300	50-203	160-300	66-203	160-300	74-200	160-300	90-203	180-300
Beam Flange Thickness t (mm)	25	40	25	40	25	40	25	40	25	40
Net Weight (kg)	9.7	12.6	11.2	14.1	18	21.3	35.4	39.2	51.8	56

Beam Clamp BCA series

- Very easy tCapacity 1 to 10 ton.
- Clamp jaw is designed to reduce flange stress by distributing load away from I-beam flange edge.
- Can be mounted easily with threaded handle.
- Fits a wide range of flange widths and beams.
- Suspension bar provides lower headroom.
- Customer's specification or OEM is available.
- Conforms to CE safety standard.
- Conforms to ANSI/ASME safety standard.

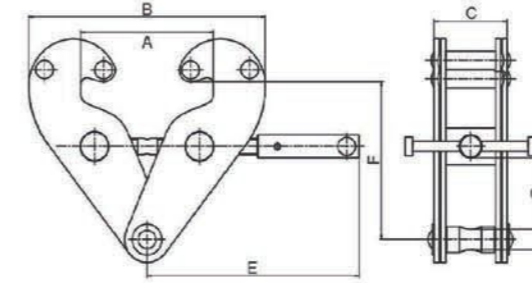

Model No.	BC10A	BC20A	BC30A	BC50A	BC100A	
Load Capacity (tonne)	1	2	3	5	10	
I-Beam Width (mm)	75-220	75-220	80-320	80-320	90-320	
Test Road (KN)	12.3	24.5	36.8	61.3	122.5	
Net Weight (kg)	3.8	4.6	9	11	17	
Dimensions	A(mm)	260	260	354	354	365
	B(mm)	180/360	180/360	235/490	235/490	320/505
	C(mm)	64	74	103	110	120
	E(mm)	215	215	260	260	280
	F(mm)	102/155	102/155	140/225	140/225	170-235
	G(mm)	25	25	45	45	50

Beam Clamp BCB series

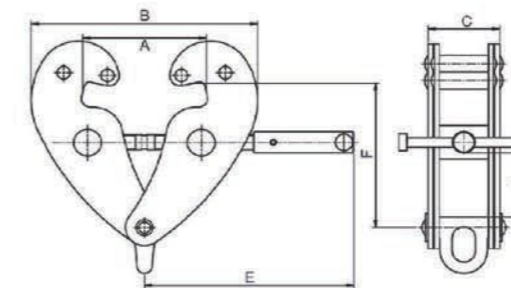

Model No.	BC10B	BC20B	BC30B	BC50B	BC100B	
Load Capacity (tonne)	1	2	3	5	10	
I-Beam Width (mm)	75-230	75-230	80-320	90-320	90-320	
Test Road (kn)	12.3	24.5	36.8	61.3	122.5	
Net Weight (kg)	3.8	5	9	11	18.6	
Dimensions	A(mm)	260	290	354	354	365
	B(mm)	180/360	185/400	235/490	235/490	320/505
	C(mm)	64	85	103	110	120
	E(mm)	215	215	260	260	280
	F(mm)	102/155	90/165	140/225	140/225	170-235
	G(mm)	25	25	45	45	50

Vertical Plate Clamp VDA series (Lever Lock)

Professional class

- The Vertical Hinged Lifting Clamp is suitable for the lifting, turning (180°) and vertical transfer of steel plates and constructions.
- It is fitted with a locking device.
- Fitted with a hinged hoisting eye moving in all directions so as to enable the user to place and lift the load from any direction.
- The lifting clamps are fitted with special hook-up facilities to enable easy fitment of the clamp in horizontal position.
- The new models have a greater jaw aperture enabling plates of varying thickness to be lifted with the same clamp.
- **Conforms to CE safety standard.**

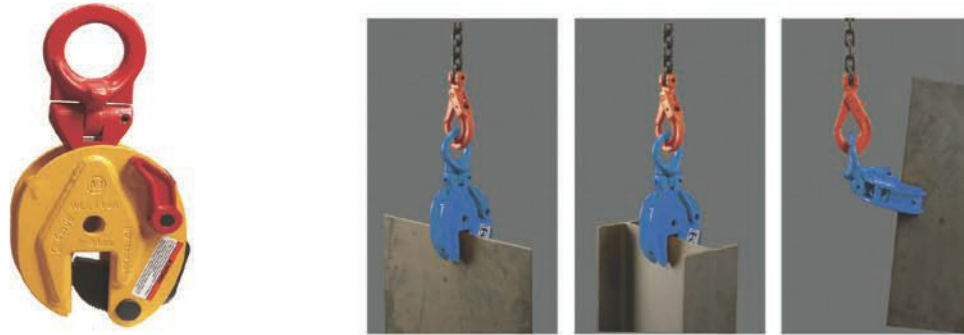

Model No.	VDA05	VDA10	VDA20	VDA30	VDA50	VDA80
Load Capacity (kg)	500	1000	2000	3000	5000	8000
Jaw Opening (mm)	0-15	0-20	0-25	0-30	0-50	0-45
Overall Length (mm)	212	295	370	418	458	508
Lifting Hole (mm)	30	48	70	75	75	75
Net Weight (kg)	2	5	8	15	23	37

Vertical Plate Clamp VDB series (Hand Lock)

Professional class

- Vertical lift and turn objects in one smooth operation.
- Hardened steel jaws for secure grip, and cam mechanism engages as vertical pressure is applied to hook ring.
- Conforms to ANSI/ASME safety standard.

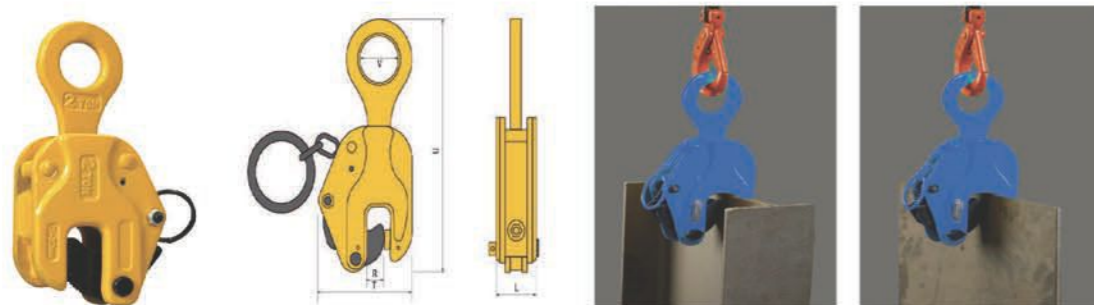

Model No.	VDB10	VDB20	VDB30	VDB50
Load Capacity (kg)	1000	2000	3000	5000
Jaw opening (mm)	0-22	0-32	0-36	0-50
Dimension T (mm)	125	152	170	226
Dimension U (mm)	280	330	400	460
Dimension U (mm)	48	48	60	60
Dimension L (mm)	54	62	73	78
Net Weight (kg)	4.3	7.2	10.7	17.3

Round Stock Grab VDP series

- For horizontal lifting and transporting of steel and concrete pipes.
- Designed to pick up tubes, pipes and rolls or similar round stock material with a diameter of up to 320mm.
- They are extremely easy and simple to use and make for safe lifting.
- Available with automatic open/close device.



Model No.	VDP05	VDP10	VDP20	VDP30	VDP50
Load Capacity (kg)	500	1000	2000	3000	5000
Jaw Opening (mm)	50-100	50-100	80-130	120-220	200-300
Dimension A (mm)	160	160	235	410	500
B (mm)	204	204	340	340	574
C (mm)	46	46	72	100	152
D (mm)	50	50	55	60	80
Net Weight (kg)	3.2	4.1	16	32	104

Concrete Pipe Lifting Clamp PLG series

- Lifting clamp for the vertical transport of concrete pipe and culverts must be very versatile.
- Most important it must be absolutely safe and easy to handle under even the harshest conditions.
- It is a three-legged lifting system for the safe and non-marring transport of concrete pipes up to a diameter of 2000mm and a load of up to 3t.
- The jaw capacity is designed for concrete pipe thickness from 40-200mm.
- Attachment and removal of the clamps can be done easily due to the handles that have been incorporated into each clamp.
- Solid construction.
- Type-tested 4:1 against breakage.
- For heavy duty use, but light weight design.
- For concrete pipes according to DIN4034.

Model No.	PLG15	PLG30A	PLG30B
Load capacity (kg)	1500	3000	3000
Jaw opening Z (mm)	40-120	50-180	90-220
Grip depth E (mm)	165	245	245
Pressure Line F (mm)	100	175	175
Dimension A (mm)	135	180	180
Dimension B (mm)	75	100	100
Dimension C (mm)	18	26	26
Dimension D (mm)	180	310	310
Net Weight (kg)	10	18	24



Permanent Magnet Lift PML series

- Magnetic lifters are designed for material handling and provide a lightweight, cost-effective means of transporting ferrous material such as moulds and parts.
- Magnetic lifters hold workloads securely without the need for slings, clamps or other holding devices.
- Full safety designed lifter work with permanent magnets without any additional power supply.
- Steel housing secures magnets for maintenance free operation.
- The magnanen magnets are shielded from all outside interference and can't lose magnetism, Bi-polar design allows for lifting of flats, rounds, and angle stock.
- Magnetic field is controlled by the locking "on-off" position of the handle, very easy to operate.
- Cautions:
Surface condition, material thickness, surface finish and weight of the workload are factors that will affect the overall performance of magnetic lifters.

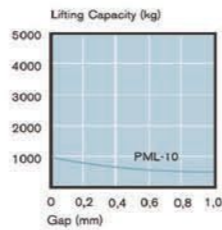
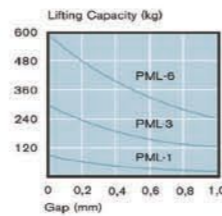
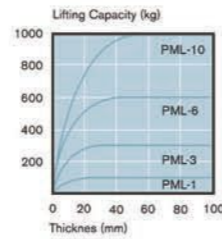
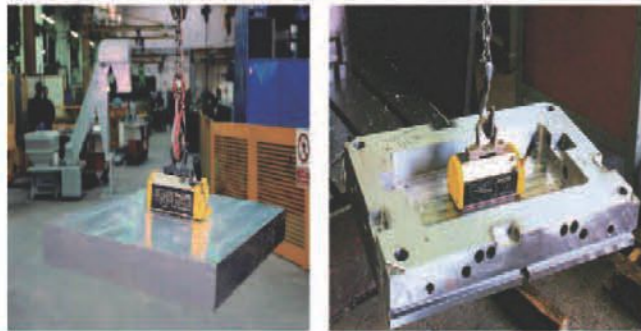
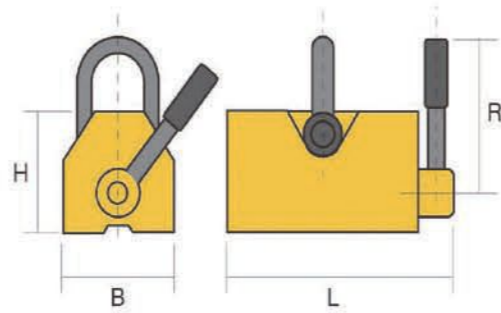
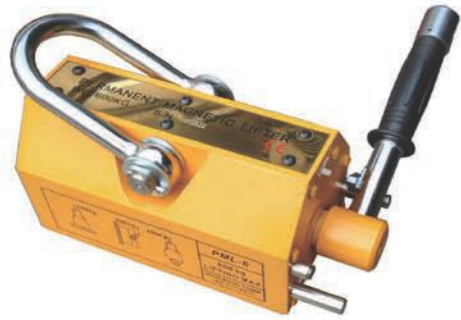

Model No.	PML-1	PML-2	PML-3	PML-5	PML-6	PML-10	PML-15	PML-20	PML-30	PML-50	PML-60
Load Capacity (kg)	100	200	300	500	600	1000	1500	2000	3000	5000	6000
Cylindrical Capacity (kg)	30	60	100	150	200	300	500	600	1000	1500	2000
Max Tear-off strength (kgf)	350	700	1050	1750	2100	3500	5200	7000	10500	17500	19200
Length (mm)	92	158	165	216	236	264	353	378	453	647	713
Width (mm)	64	64	88	118	118	168	172	230	290	290	290
Height (mm)	70	70	96	120	120	168	168	217	265	265	265
Handle Length (mm)	142	142	176	219	219	266	380	462	567	707	707
Net Weight (kg)	3	5	10	20	24	50	70	125	220	355	298

Grip Puller GP / GPA series

The grip puller is operable in the vertical, horizontal and diagonal planes, with a safe working load of 800, 1600 or 3200kg.

- Accurate operation.
- Virtually maintenance-free.
- Body made of high-strength cast aluminium with low own weight.
- Shearing pin breaks at 25% overload and operating lever bends at an overload of approximately 50%.
- Shearing pin can be replaced under full load.
- Spare shearing pins are located in the transport handle or in the operating lever (GP-0.8).
- Wire rope set; the standard wire rope length is 20 metres, 30, 40, 50 meters are available as option.
- **Conforms to CE safety standard.**

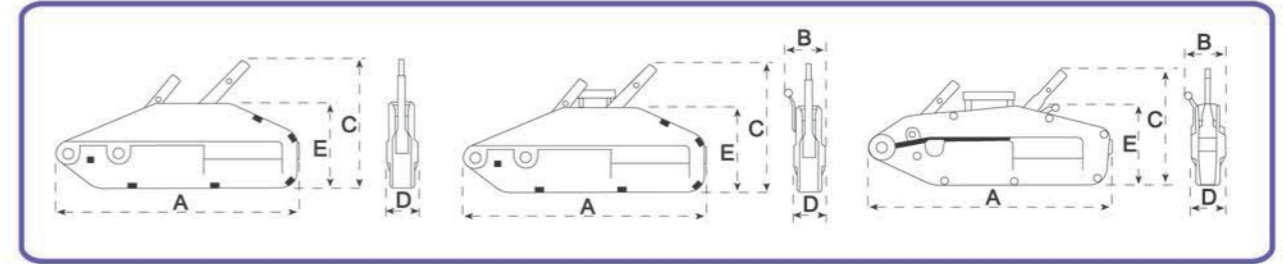

- GPA series:
- More convenient and safer.
 - The hook can be swivelled 360° instead of the pin in GP series.

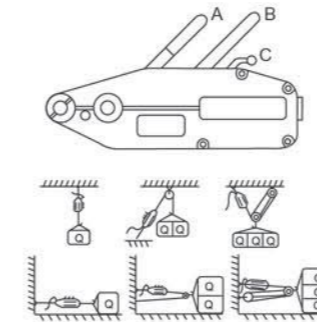

Type	GP/GPA-0.8	GP/GPA-1.6	GP/GPA-3.2
A	426	545	660
B	64	97	116
C (mm)	235	280	325
D	59	72	94
E	170	190	220

Type	GP-0.8	GP-1.6	GP-3.2	GPA-0.8	GPA-1.6	GPA-3.2
WLL (Vertical) (kg)	800	1600	3200	800	1600	3200
Hand Effort Max. (kg)	32	42	44	32	42	44
Lever Length (mm)	740	1120		740	1120	
Wire rope Diameter (mm)	8.3	11	16	8.3	11	16
Lifting Height at 1 Movement of Lever (mm)	52	55	28	52	55	28
Weight without Rope (kg)	6.4	12.4	23.3	6.4	12.4	23.3
Weight 20m Rope (kg)	7	11.5	23	7	11.5	23

Manual Winch WHA / WHB series

- Manual winch is built for multi-purpose hauling and pulling operations.
- It can be used to pull and haul wheeled equipment short distances.
- It should not be used to secure a load.
- It is not recommended for lifting.
- It is not to be used as hoists for lifting, supporting, or transporting people or for loads over areas where people could be present.

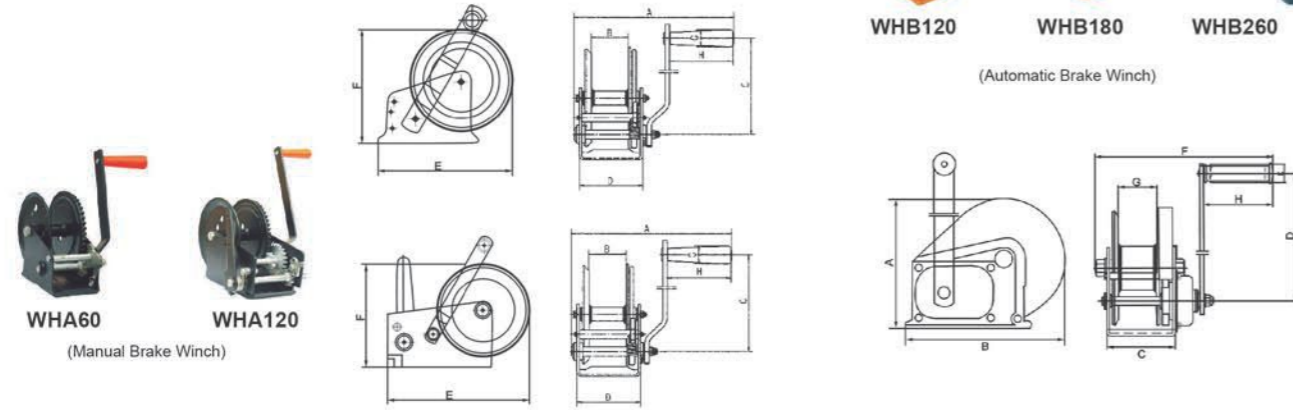

Model No.	WHA60	WHA80	WHA100	WHA120	WHA140	WHA200	WHA250	WHB120	WHB180	WHB260
Capacity	(kg)	272.4	363.2	454	545	635	908	1135	544.8	1180.4
	(lb)	600	800	1000	1200	1400	2000	2500	1200	2600
Gear Ratio		2.9:1	3.7:1	4.2:1	4.2:1	4.2:1	10.35:1/4.5:1	11.5:1/5:1	4.2:1	5:1
Net Weight	(kg)	2.5	2.6	2.8	2.8	2.8	6.2	6.5	3.7	10.1
No of Speed		Single	Single	Single	Single	Single	Double	Double	—	—
Dimension	A	232	232	232	232	232	310	310	156	216
	B	51	51	51	51	51	65	65	184	293
	C	180	180	180	180	180	251	251	88	107
	D	88	88	88	88	88	129.5	129.5	210	319
	E	165	165	184	184	184	243	259	27	27
	F	138	138	156	156	156	178	190	272	283
	G	25	25	25	25	25	25	25	51	60
	H	90	90	90	90	90	90	90	109	109

Worm Gear Winch WHC series

- Worm gear winch is built for multi-purpose hauling and pulling operations that require a positive mechanism for braking.
- It is not recommended for lifting applications.
- It is not to be used as hoists for lifting, supporting, or transporting people or for loads over areas where people could be present.

Model	WHC15	WHC20	WHC25	WHC30	
Rated Pull	lbs(kg)	1500(680)	2000(900)	2500(1100)	3000(1350)
Cable Size	Diameter (mm)	Φ4.8	Φ5.0	Φ5.6	Φ8.0
	Length (m)	15		30	18
Gear Ratio		31:1	41:1	51:1	
Module	(mm)	3			
Handle Length	(mm)	280		285	
Drum-Hub Dia.	(mm)	Φ38		Φ50	Φ80



Ratchet Load Binder

- Reliable design for safety and easy operation.
- High quality drop forged construction.
- Heat treated for extra strength.
- Short reach hooks provide optimum take-up.
- Each binder individually proof tested.
- No requirement for locking of handle unlike lever type load binders.
- Conforms to CE safety standard.**

Min-Max China Size (in.)	1/4-5/16	5/16-3/8	3/8-1/2	1/2-5/8	
Working Load Limited (lbs)	2600	5400	9200	11000	
Proof Load (lbs)	5200	10800	18400	26000	
Minimum Ultimate Load (lbs)	7800	19000	33000	46000	
Weight (lbs)	3.52	10.50	12.90	14.38	
Handle Length (in.)			13.92		
	L1	7.16			
	L2	0.89	1.30		
	L3	1.77	2.60		
Dimensions (in.)	L4	16.22	22.64	24.13	26.45
	L5	21.26	30.64	32.13	34.45
	L6	17.79	25.24	27.04	30.07
	L7	22.83	33.24	35.04	38.07
	L8	0.35	0.51	0.59	0.74

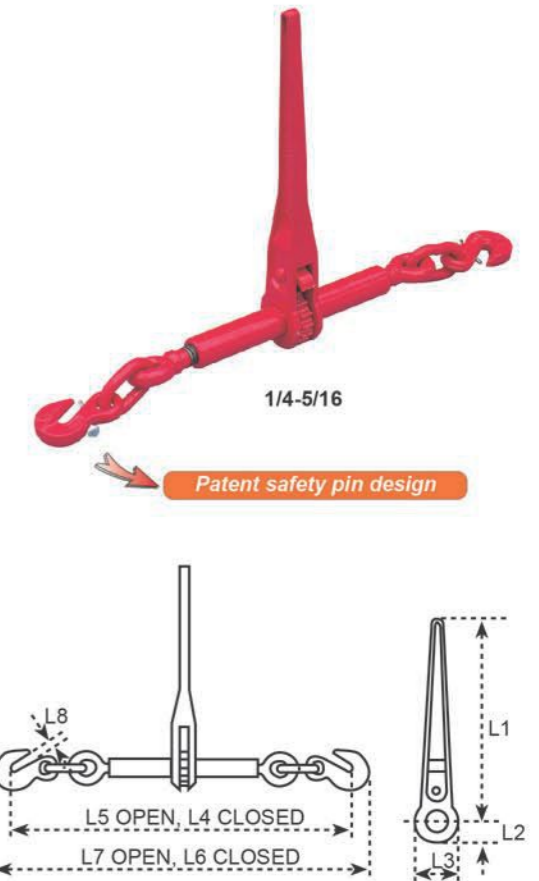

Lever Load Binder

- Safe, reliable design for all heavy duty transport use. (take up slack and apply tension to a tie down system)
- Drop forged steel, high strength.
- Free 360 degree swivel hooks for easier handling.
- Heat-treated for extra strength.
- Each binder individually proof tested.

Min-Max China Size (in.)	1/4-5/16	5/16-3/8	3/8-1/2	3/8-1/2	1/2-5/8
Working Load Limited (lbs)	2600	5400	9200	9200	11000
Proof Load (lbs)	5200	10800	18400	18400	22000
Minimum Ultimate Load (lbs)	7800	19000	28000	33000	44000
Weight (lbs)	3.52	8.37	12.11	12.20	19.7
Handle Length (in.)			17.24		21.00
	h1	18.5	25.2	28.5	33.86
	h2	17.3	23.2	26.38	30.12
	h3	14.17	19.49	22.05	25.78
Dimensions (in.)	h4	11.42	15.55	17.64	20.87
	h5	8.27	11.22	12.99	14.37
	h6	8.07	11.22	12.20	14.37
	h7	0.35	0.51	0.59	0.74

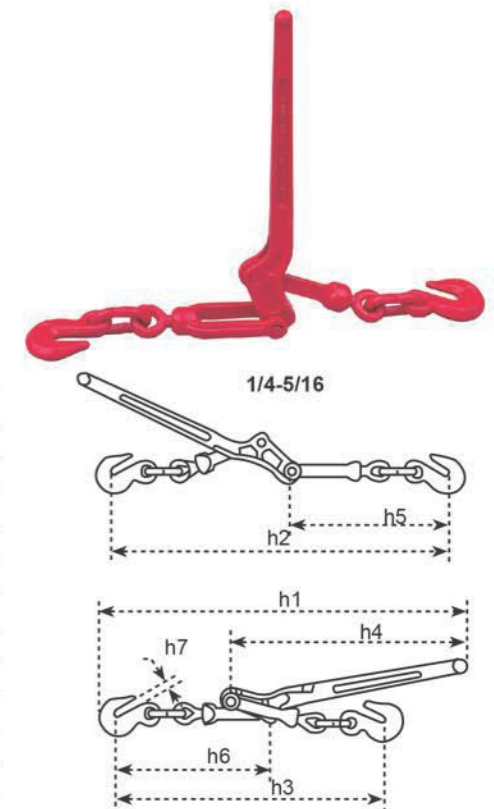

Cargo Lashing

- Logislift's cargo-lashings are produced from high tenacity polyester yarns.
- Low-strain, wear-resistant, long-life strap material (100% polyester).
- Various end fittings are available to suit specific lashing needs.
- In accordance with DIN 60060 and pr-EN 12195-2.

For Europe

Type	R2035A, R2035B, R2035C, R2035D, R4035N					
Model	R2035A	R2035B	R2035C	R2035D	R4035N	
Load Capacity System (daN)	2000				4000	
Load Capacity System (daN)	1000				2000	
Breaking Strength Webbing (daN)	3000					
Webbing Width (mm)	35					
End Fitting	Grab hook	One top grab hook	Claw hook	Twisted snap hood	Endless	

Fixed end: 0.5m. Standard length: R2050A to 2050E 6m, R4050N 6m(Endless)

Type	R4050A, R4050B, R4050C, R4050D, R4050E, R8050N						
Model	R4050A	R4050B	R4050C	R4050D	R4050E	R8050N	
Load Capacity System (daN)	4000				8000		
Load Capacity System (daN)	2000				4000		
Breaking Strength Webbing (daN)	6000						
Webbing Width (mm)	50						
End Fitting	Grab hook	One top grab hook	Claw hook	Twisted snap hook	Hook with safety latch	Endless	

Fixed end:0.5m. Standard length: R4050A to 4050E 8m, R8050N 6m(Endless)

Type	R5050A, R5050B, R5050C, R5050D, R5050E, R10050N					
Model	R5050A	R5050B	R5050C	R5050D	R5050E	R10050N
Load Capacity System (daN)	5000				10000	
Load Capacity System (daN)	2500				5000	
Breaking Strength Webbing (daN)	7500					
Webbing Width (mm)	50					
End Fitting	Grab hook	One top grab hook	Claw hook	Twisted snap hook	Hook with safety latch	Endless

Fixed end: 0.5m. Standard length: R5050A to 5050E 8m, R10050N 6m(Endless). 9m and 10m available.

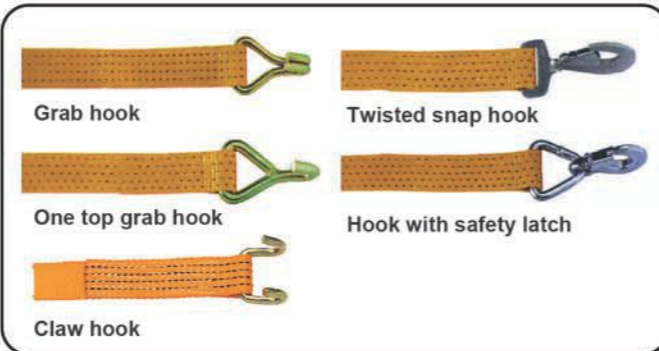
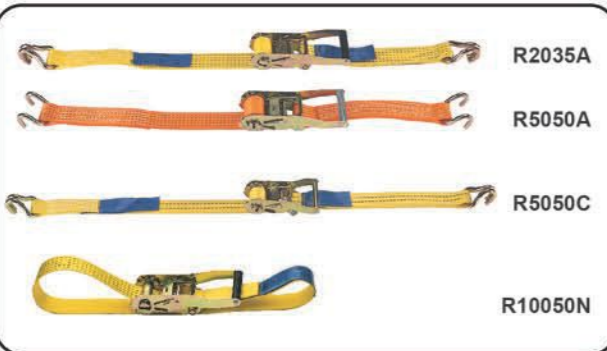

Cargo Lashing

Logislift Type Cargo Lashings are made from PU-coated polyester for minimum stretch and maximum resistance, and manufactured according to CVSA guidelines, DOT regulations and WSTDA recommended standards.

1. Tiedown Ratchet assemblies



TD series

Model No.	TD11007	TD21516A	TD22716A	TD21516B	TD22716B	TD21533A	TD22733A	TD21533B	TD22733B
Size	1"x10'	2"x15'	2"x27'	2"x15'	2"x27'	2"x15'	2"x27'	2"x15'	2"x27'
WLL (lbs)	700	1600				3300			
Assembly Breaking Strength (lbs)	2100	4800				10000			
End Fittings	Vinyl S Hook	Flat hook		St.Snap hook		Flat hook		St.Snap hook	

Model No.	TD32750A	TD33050A	TD32750B	TD33050B	TD42750A	TD43050A	TD42750B	TD43050B
Size	3"x27'	3"x30'	3"x27'	3"x30'	4"x27'	4"x30'	4"x27'	4"x30'
WLL (lbs)	5000							
Assembly Breaking Strength (lbs)	15000							
End Fittings	Flat hook		Delta ring		Flat hook		Delta ring	

2. Logistic Straps



STR series

Model No.	STR21208	STR21608	STR22008	STR21210	STR21610	STR22010	STR21210	STR21610
Size	2"x12'	2"x16'	2"x20'	2"x12'	2"x16'	2"x20'	2"x12'	2"x16'
WLL (lbs)	800			1000				
Assembly Breaking Strength (lbs)	2400			3000				
End Fittings	Cam Buckle, E Tack,			Ratchet, E Tack,			Ratchet, 3-piece fitting,	
	Yellow Webbing	Grey Webbing	Blue Webbing	Yellow Webbing	Grey Webbing	Blue Webbing	Yellow Webbing	Grey Webbing

Model No.	STR22010	STR21208	STR21208	STR21208	STR21208	STR21208	STR21208
Size	2"x20'	2"x12'	2"x16'	2"x20'	2"x12'	2"x16'	2"x20'
WLL (lbs)	1000	420			735		
Assembly Breaking Strength (lbs)	3000	1250			2200		
End Fittings	Ratchet, 3-piece fitting,	Ratchet, Butterfly fitting,			Ratchet, Plate trailer hook,		
	Blue Webbing	Yellow Webbing	Grey Webbing	Blue Webbing	Yellow Webbing	Grey Webbing	Blue Webbing

Flat Webbing Sling W25 series

For Europe

- Logislift's flat webbing slings are made from high tensile polyester (PES).
- Manufactured according to machine directive 89/392/CE and DIN61360.
- Low elongation.
- Color coded according to DIN-EN1492-1.
- Each 25mm webbing width is equal to 1 tonne capacity.
- UV-resistant, eliminating material aging or embrittlement.
- Moisture-resistant fabric, thus preventing frost damage (up to approx. -40°C).



W25-3

Model No.				W25-1	W25-2	W25-3	W25-4	W25-5	W25-6	
Webbing Width			(mm)	25	50	75	100	125	150	
Colour Coded According to DIN-EN1492-1				WLL 1T	WLL 2T	WLL 3T	WLL 4T	WLL 5T	WLL 6T	
Working Load Limit with 1 Webbing Sling	Straight Lift		1,0	1.000	2.000	3.000	4.000	5.000	6.000	
	Chocked Lift		0,8	800	1.600	2.400	3.200	4.000	4.800	
		β	0-7°		2,0	2.000	4.000	6.000	8.000	10.000
			7°-45°		1,4	1.400	2.800	4.200	5.600	7.000
	45°-60°		1,0	1.000	2.000	3.000	4.000	5.000		
Working Load Limit with 2 Webbing Sling	Straight Lift up to 45°		1,4	1.400	2.800	4.200	5.600	7.000	8.400	
	Chocked Lift up to 45°		1,12	1.120	2.240	3.360	4.480	5.600	6.720	
	Straight Lift 45°-60°		1,0	1.000	2.000	3.000	4.000	5.000	6.000	
	Chocked Lift 45°-60°		0,8	800	1.600	2.400	3.200	4.000	4.800	

Usual length 1m, 1.5m, 2m, 2.5m, 3m, 4m, 5m, 6m, 7m, 8m, 10m

Flat Webbing Sling W30 series

For Europe

- Logislift's flat webbing slings are made from high tensile polyester (PES).
- Manufactured according to machine directive 89/392/CE and DIN61360.
- Low elongation.
- Color coded according to DIN-EN1492-1.
- Each 30mm webbing width is equal to 1 tonne capacity.
- UV-resistant, eliminating material aging or embrittlement.
- Moisture-resistant fabric, thus preventing frost damage (up to approx. -40°C).



W30-3

Model				W30-1	W30-2	W30-3	W30-4	W30-5	
Webbing Width			(mm)	30	60	90	120	150	
Colour Coded According to DIN-EN1492-1				WLL 1T	WLL 2T	WLL 3T	WLL 4T	WLL 5T	
Working Load Limit with 1 Webbing Sling	Straight Lift		1,0	1.000	2.000	3.000	4.000	5.000	
	Chocked Lift		0,8	800	1.600	2.400	3.200	4.000	
		β	0-7°		2,0	2.000	4.000	6.000	8.000
			7°-45°		1,0	1.000	2.000	3.000	4.000
	45°-60°		0,7	700	1.400	2.100	2.800		
Working Load Limit with 2 Webbing Sling	Straight Lift up to 45°		1,4	1.400	2.800	4.200	5.600	7.000	
	Chocked Lift up to 45°		1,12	1.120	2.240	3.360	4.480	5.600	
	Straight Lift 45°-60°		1,0	1.000	2.000	3.000	4.000	5.000	
	Chocked Lift 45°-60°		0,8	800	1.600	2.400	3.200	4.000	

Usual length 1m, 1.5m, 2m, 2.5m, 3m, 4m, 5m, 6m, 7m, 8m, 10m

Flat Webbing Sling SEN series

For USA



SEN-1

Plies of Web		One Ply						Two Ply						
Model		SEN1-1	SEN1-2	SEN1-3	SEN1-4	SEN1-5	SEN1-6	SEN2-1	SEN2-2	SEN2-3	SEN2-4	SEN2-5	SEN2-6	
Web Width (in.)		1	2	3	4	5	6	1	2	3	4	5	6	
Rated Capacity (lbs)	Vertical		2400	4800	6600	8800	11000	13200	4800	9600	12500	15500	19400	23000
	Chocker		2560	3840	5280	7040	8800	10560	3840	7680	10000	12400	15520	18400
	Vertical Basket		4800	9600	13200	17600	22000	26400	9600	19200	25000	31000	38800	46000
	≥60° Basket		4080	8160	11220	14960	18700	22440	8160	16320	21250	26350	32980	39100
	45°≤Y60° Basket		3360	6720	9240	12320	15400	18480	6720	13440	17500	21700	27160	32200
	30°≤Y45° Basket		2400	4800	6600	8800	11000	13200	4800	9600	12500	15500	19400	23000

Usual length 3ft, 4ft, 5ft, 6ft, 8ft, 10ft, 12ft, 15ft, 20ft, 25ft, 30ft.

Flat Webbing Sling SFW series

For USA

- Logislift's flat webbing slings meet or exceed current U.S. industry and government requirements of OSHA and ASME B30.9, and can be modified according to local standard as required.
- Class 5 webbing possessing a minimum certified tensile strength of 6800lbs/in. width.



SFW2-2

SFW1-2

Plies of Web		One Ply						Two Ply						
Model		SFW1-1	SFW1-2	SFW1-3	SFW1-4	SFW1-5	SFW1-6	SFW2-1	SFW2-2	SFW2-3	SFW2-4	SFW2-5	SFW2-6	
Web Width (in.)		1	2	3	4	5	6	1	2	3	4	5	6	
Eye Length (in.)		8.5	10	11	12	14	16	8.5	10	11	12	14	16	
Rated Capacity (lbs)	Vertical		1200	2400	3600	4800	6000	7200	2400	4800	6500	8600	10200	12300
	Chocker		1280	2480	2880	3840	4800	5760	2560	3840	5200	6880	8160	9840
	Vertical Basket		3200	6200	7200	9600	12000	14400	4800	9600	13000	17200	20400	24600
	≥60° Basket		2720	5270	6120	8160	10200	12240	4080	8160	11050	14620	17340	20910
	45°≤Y60° Basket		2240	4340	5040	6720	8400	10080	3360	6720	9100	12040	14280	17220
	30°≤Y45° Basket		1200	2400	3600	4800	6000	7200	2400	4800	6500	8600	10200	12300

Usual length 3ft, 4ft, 5ft, 6ft, 8ft, 10ft, 12ft, 15ft, 20ft, 25ft, 30ft.

Round Sling R series

For Europe

- Logislift's round slings are easy to use, efficient in operation and gentle on surface contact. All round slings are colour coded to give easy identification of the safe working load. They come with a label giving length and tonnage.
- The round sling inner core is made from high tensile polyester fibre which is wound continuously without a join to provide the maximum possible strength.
- This core is protected by a tough woven tubular sleeve also made from polyester without side stitch. It serves to protect both the inner core of the sling and the surface of the product when it is lifting.
- Polyester round sling with two poly woven heavy sleeve.
- Manufactured according to machine directive 89/392/CE.
- Color coded according to DIN-EN1492-2.
- Capacity stripes: each stripe is equal to 1 tonne capacity.
- The safe working load is clearly and continuously printed on the sleeve.
- Low elongation, extremely wear-resistant.



Model No.		R10	R20	R30	R40	R50	R60	R80	R100	R120		
Colour		Purple	Green	Yellow	Grey	Red	Brown	Blue	Orange	Orange		
Colour Coded According to DIN-EN1492-2		WLL 1T	WLL 2T	WLL 3T	WLL 4T	WLL 5T	WLL 6T	WLL 8T	WLL 10T	WLL 12T		
Working Load Limit with 1 Round Sling	Straight lift	1.0	1.000	2.000	3.000	4.000	5.000	6.000	8.000	10.000	12.000	
	Chocked lift	0.8	800	1.600	2.400	3.200	4.000	4.800	6.400	8.000	9.600	
	β	0-7°	2.0	2.000	4.000	6.000	8.000	10.000	12.000	16.000	20.000	24.000
		Bis7°	1.4	1.400	2.800	4.200	5.600	7.000	8.400	11.200	14.000	16.800
		7°-45°	1.0	1.000	2.000	3.000	4.000	5.000	6.000	8.000	10.000	12.000
		45°-60°	0.7	700	1.4	2.100	2.800	3.500	4.200	5.600	7.000	8.400
45°-60°	0.5	500	1.000	1.500	2.000	2.500	3.000	4	5.000	6.000		
Working Load Limit with 2 Round Slings	Straight Lift up to 45°	1.4	1.400	2.800	4.200	5.6	7.000	8.4	11.200	14.000	16.800	
	Chocked Lift up to 45°	1.12	1.120	2.240	3.360	4.480	5.600	6.720	8.960	11.200	13.440	
	Straight Lift 45°-60°	1.0	1.000	2.000	3.000	4.000	5.000	6.000	8.000	10.000	12.000	
	Chocked Lift 45°-60°	0.8	800	1.600	2.400	3.200	4.000	4.800	6.400	8.000	9.600	

Note: Please add length after model. For example, R10-3 means R10 with 3 meters length.

Round Sling URS series

For USA

- Logislift's Round Slings meet or exceed current U.S. industry and government requirements of OSHA and ASME B30.9, and can be modified according to local standard as required.
- Double wall covers protects load yarns.
- Color coded to indicate capacity.



Model No.		URS25	URS50	URS85	URS130	URS210	URS250	URS310	URS400	URS530
Color		Purple	Green	Yellow	Red	Blue	Orange	Grey	Orange	Brown
Rated Capacity (lbs)	Vertical	2600	5300	8400	13200	21200	25000	31000	40000	53000
	Chocker	2080	4240	6720	10560	16960	20000	24800	32000	42400
	Vertical Basket	5200	10600	16800	26400	42400	50000	62000	80000	106000
	≥60° Basket	4420	9010	16800	22440	36040	42500	52700	68000	90100
	45°≤Y60° Basket	3640	7420	11760	18480	29680	35000	43400	56000	74200
	30°≤Y45° Basket	2600	5300	8400	13200	21200	25000	31000	40000	53000

Usual length 3ft, 4ft, 5ft, 6ft, 8ft, 10ft, 12ft, 15ft, 20ft, 25ft, 30ft.

Flat Webbing Sling ED series

For USA

Professional class

B. Endless Slings



Plies of Web		One Ply						Two Ply					
Model		ED1-1	ED1-2	ED1-3	ED1-4	ED1-5	ED1-6	ED2-1	ED2-2	ED2-3	ED2-4	ED2-5	ED2-6
Web Width (in.)		1	2	3	4	5	6	1	2	3	4	5	6
Rated Capacity (lbs)	Vertical	3200	6400	8800	11500	13700	16500	6200	12200	16700	20700	24600	28600
	Chocker	2560	5120	7040	9200	10960	13200	4960	9760	13360	16560	19680	22880
	Vertical Basket	6400	12800	17600	23000	27400	33000	12400	24400	33400	41400	49200	57200
	≥60° Basket	5440	10880	14960	19550	23290	28050	10540	20740	28390	35190	41820	48620
	45°≤Y60° Basket	4480	8960	12320	16100	19180	23100	8680	17080	23380	28980	34440	40040
	30°≤Y45° Basket	3200	6400	8800	11500	13700	16500	6200	12200	16700	20700	24600	28600

Usual length 3ft, 4ft, 5ft, 6ft, 8ft, 10ft, 12ft, 15ft, 20ft, 25ft, 30ft.

Flat Webbing Sling HFW series

For USA

Professional class

- Logislift's flat webbing slings meet or exceed current U.S. industry and government requirements of OSHA and ASME B30.9, and can be modified according to local standard as required.
- Class 7 webbing possessing a minimum certified tensile strength of 9800lbs/in. width.

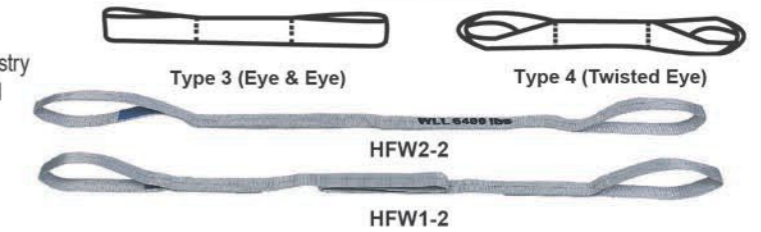

Plies of Web		One Ply						Two Ply											
Model		HFW1-1	HFW1-2	HFW1-3	HFW1-4	HFW1-5	HFW1-6	HFW2-1	HFW2-2	HFW2-3	HFW2-4	HFW2-5	HFW2-6						
Web Width (in.)		1	2	3	4	5	6	1	2	3	4	5	6						
Eye Length (in.)		8.5	10	11	12	14	16	8.5	10	11	12	14	16						
Rated Capacity (lbs)	Vertical	1600	3200	4700	6200	7800	9300	3200	6400	8800	11500	13700	16500						
	Chocker	1280	2560	3760	4960	6240	7440	2560	5120	7040	9200	10960	13200						
	Vertical Basket	3200	6400	9400	12400	15600	18600	6400	12800	17600	23000	27400	33000						
	≥60° Basket	2720	4480	7990	10540	13260	15810	5400	10880	14960	19550	23290	28050						
	45°≤Y60° Basket	2240	4340	6580	8680	10920	13020	4480	8960	12320	16100	19180	23100						
	30°≤Y45° Basket	1600	3200	4700	6200	7800	9300	3200	6400	8800	11500	13700	16500						
Minimum Qty. (pcs)		100			60			30			100			60			30		

Usual length 3ft, 4ft, 5ft, 6ft, 8ft, 10ft, 12ft, 15ft, 20ft, 25ft, 30ft.

Telescopic Fork Mounted Jibs TLB03/ TLB01

- ▲ Convert a forklift truck into a mobile crane to reach and transport long and awkward loads from inaccessible location.
- ▲ Verify load centre of forklift truck.
- ▲ Safety chain welded to boom has grab hools for anchoring jib boom to forklift truck.
- ▲ Zinc plated fork heels pin for safe forklift attachment.
- ▲ Supplied complete with one safety swived hook with bow shackle and one rigid hook.



Model No.	TLB03												
Positions (mm)	A	B	C	D	E	F	G	H	I	J	K	L	M
Capacity (kg)	3000	2300	1865	1570	1355	1190	1065	960	875	805	745	690	640
Fork Opening (mm)	464												
Fork Pockets (mm)	180x60												
Overall Size (mm)	2168x660x324												
Packing Size (mm)	2180x680x444												
Net Weight (kg)	188												

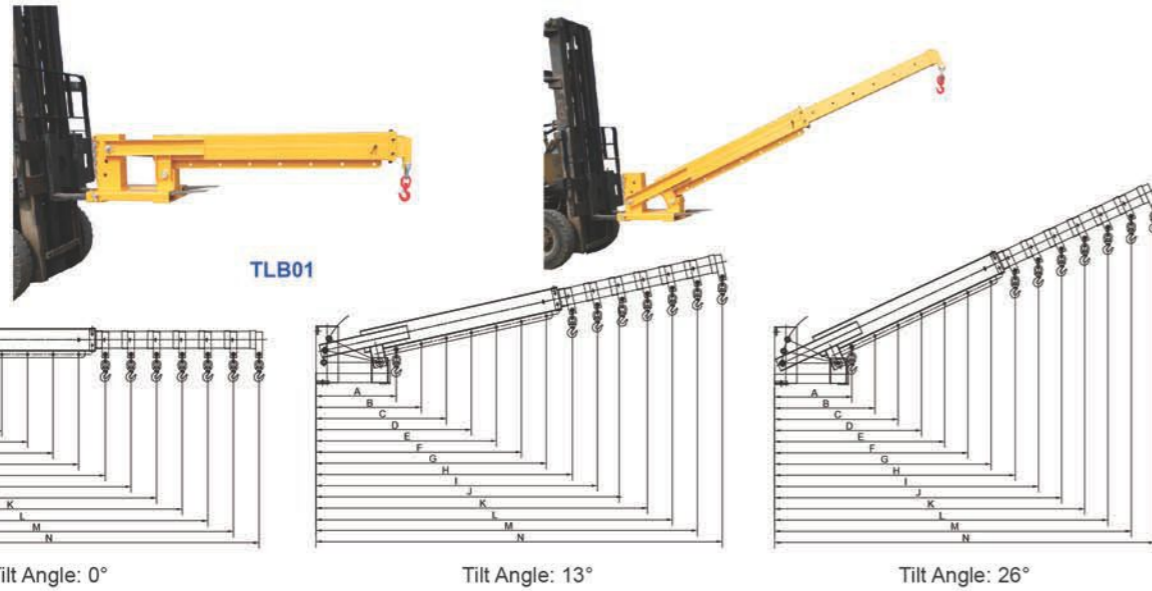

Model No.	TLB01													
Positions (mm)	A	B	C	D	E	F	G	H	I	J	K	L	M	N
0° Capacity (kg)	3000	2291	1853	1556	1341	1178	1050	944	860	790	730	679	635	596
13° Capacity (kg)	3092	2357	1906	1598	1377	1209	1078	969	882	811	749	697	651	611
26° Capacity (kg)	3217	2475	2009	1692	1460	1285	1147	1032	941	865	801	745	696	654
Fork Opening (mm)	346													
Fork Pockets (mm)	180x74													
Overall Size (mm)	2322x542x512													
Packing Size (mm)	2340x560x630													
Net Weight (kg)	240													

Lifting Clamp LH150 LH200

- ▲ Convert a forklift truck into a mobile crane to reach and transport long and awkward loads from inaccessible location.
- ▲ Verify load centre of forklift truck.
- ▲ Safety chain welded to boom has grab hools for anchoring jib boom to forklift truck.
- ▲ Zinc plated fork heels pin for safe forklift attachment.
- ▲ Supplied complete with one safety swived hook with bow shackle and one rigid hook.

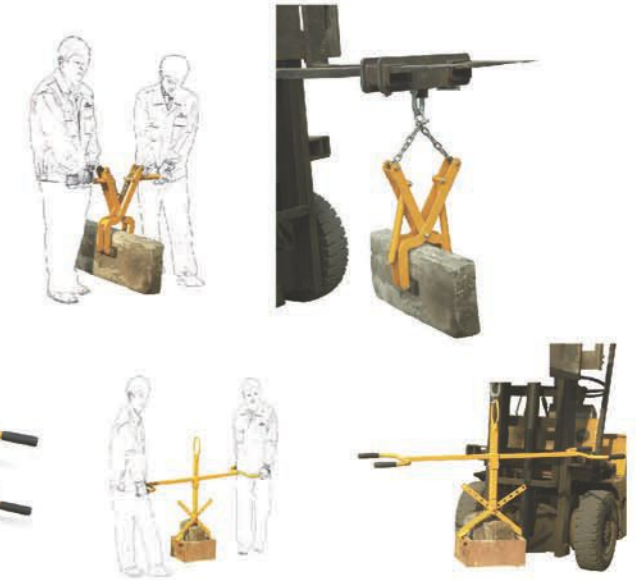

Model	LH150	LH200
Capacity (kg)	150	200
Max. Internal Open Width of Jaws (mm)	290	/
For Stringers (mm)	/	540 / 640 / 740 / 840 / 940 / 1040
Net Weight (kg)	13.2	11.5

Fork Hook MK series

- ▲ Converts forklift into a mobile crane in seconds.
- ▲ Adjustable along the length of the fork.
- ▲ Secured to forks by thumb screw.
- ▲ Swivel hook includes safety latch.

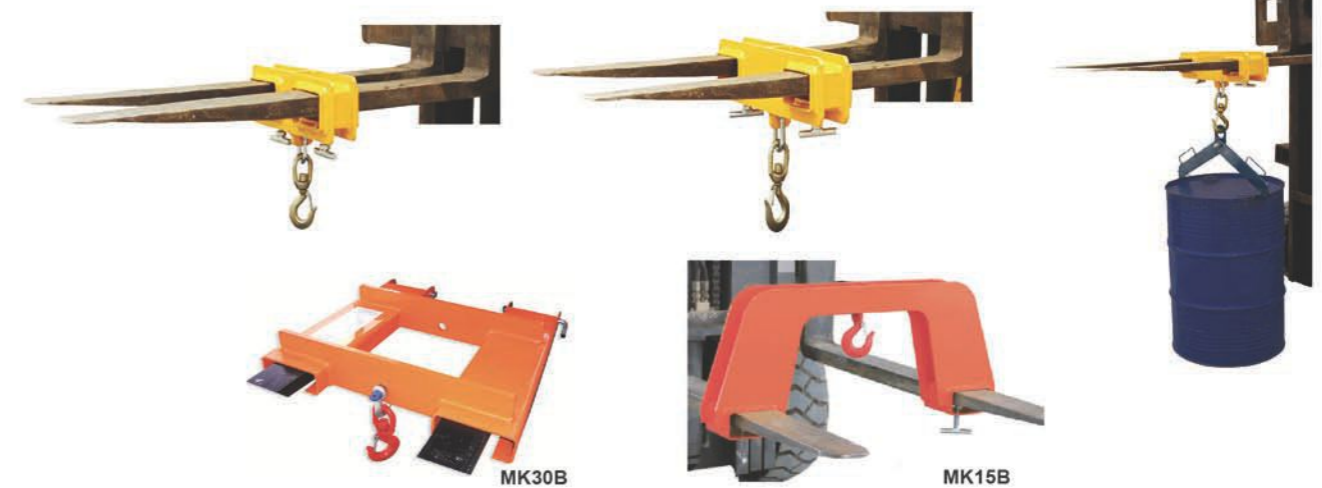
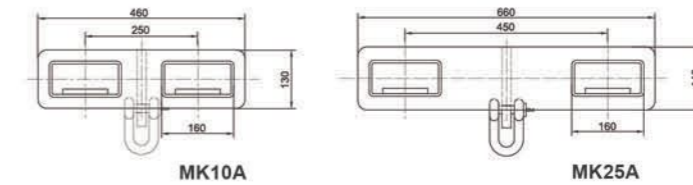

Model No.	MK10A	MK25A	MK50A	MK15B	MK30B
Capacity (kg)	1000	2500	5000	1500	3000
Max. Fork Pocket Size (mm)	140x55	148x56	188x76	150x70	160x65
Overall Size (mm)	120x460x130	150x660x140	180x730x220	1000x410x650	950x650x260
Net Weight (kg)	14	25	45	35	28

Forklift-used Safety Cage NK series

- ▲ For overhead access and maintenance with safety.
- ▲ Spring loaded inward opening door with safety latch for safety entry.
- ▲ Unit is secured to the fork with heel pins and chain.
- ▲ Slip-resistant floor with drainage holes.
- ▲ Conforms to Health and safety Guidance mte PM28 and GN48 standard.
- ▲ Less storage space, portable and easy to assemble.
- ▲ Wheel fitted for easy maneuvering.



NK30 A/B/C



NK30 D/E/F



Castors available for easy transporting.

Model	NK30A	NK30B	NK30C	NK30D	NK30E	NK30F
Max. Capacity (kg)			300			
Deck Size (mm)	950x950	1200x1000	1000x1000	950x950	1200x1000	1000x1000
Max. Height (mm)			2000			
Fork Spread (mm)			600/690			
Net Weight (kg)	68	85	80	92	107	102

Steel Container Truck

- ▲ Manual operation or attach to forklift.
- ▲ Easy toppling.



Model No.	SCT150	
Container Capacity (liter)	150	
Container Size (mm)	750x780x500	
Wheel (mm)	Φ125 x 2	
Castor (mm)	Φ125 x 1	
Fork Opening (mm)	600	
Fork Pockets (mm)	150x55	
Overall Size (mm)	1100x780x800	
Net Weight (kg)	103	

Fork Caddy FC90

- ▲ Transport fork truck forks easily and safely with our new Fork Caddy.
- ▲ This caddy also allows the user to easily remove and install forks onto a fork truck.
- ▲ The Fork Caddy has easy-grip handles and rolls smoothly on two swivel casters.
- ▲ A fork tine lock secures the caddy onto the fork to keep it in place while transporting.
- ▲ The comfort-grip handle pivots up to 180° to allow for easier mobility.
- ▲ The Fork Caddy is lightweight and small enough for easy storage as well.



Model	FC90	
Usable Size WxH (mm)	175x70	
Casters (mm)	Φ63x32	
Capacity (kg)	90	
Overall Dimension (mm)	1100x420x950	
Net Weight (kg)	13.5	

Self-Dumping Hopper SDH series

- ▲ Automatically drum when bumper release.
- ▲ Automatically return and lock when fork upright position.
- ▲ Releasing cable included.



Model No.	SDH10-25	SDH10-38	SDH18-25	SDH18-38
Load Capacity (kg/lbs)	1000/2200	1000/2200	1800/4000	1800/4000
Volume (cbm)	0.25	0.38	0.25	0.38
Overall Dimensions (mm)	1315x965x660	1315x965x840	1315x965x660	1315x965x840
Fork Pocket center (mm)	457	457	457	457
Net Weight (kg)	110	120	130	145

Fork Extensions EX series

- ▲ The simple but effective way of lengthening your forks to handle longer loads safely without damage to the load.
- ▲ Heavy duty steel construction, fit onto forks up to 50mm (2") thickness.
- ▲ Steel retaining strap prevents forks extensions from sliding off forks during use.
- ▲ Sold in pair only.



Model	EX484	EX604	EX724	EX844	EX964	EX485	EX605	EX725	EX824	
Length of Extension	(inch)	48	60	72	84	96	48	60	72	82
	(mm)	1219	1500	1830	2134	2435	1219	1500	1830	2085
Fit Fork Width	(inch)	4				5				4
	(mm)	100				125				100
Net Weight (Per pair)	(lbs)	77.5	97	116	136	155	87	108	130	133
	(kg)	35	44	53	62	70	39	49	59	60

Model	EX825	EX845	EX965	EX486	EX606	EX726	EX846	EX966	
Length of Extension	(inch)	82	84	96	48	60	72	96	
	(mm)	2085	2134	2435	1219	1500	1830	2435	
Fit Fork Width	(inch)	5				6			
	(mm)	125				150			
Net Weight (Per pair)	(lbs)	148	152	173	94	117.5	141	188	
	(kg)	67	69	79	43	53	64	85	